



**PLAY SYSTEMS, INC.®**  
FINE RESIDENTIAL PLAY EQUIPMENT

## **Carnival Clubhouse**

Assembly Instructions

5-70-0424

(Rev 1 -3/7/17)

**Contains Assembly, Use, and Maintenance Instructions**

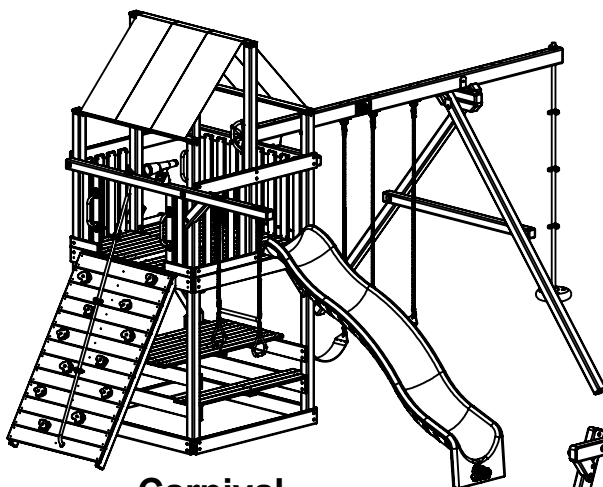

**Carnival  
Clubhouse**

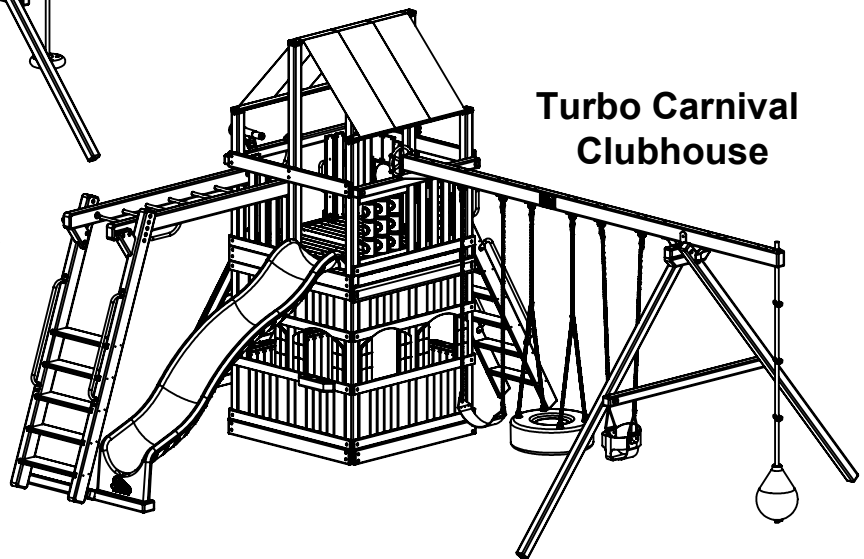

**Turbo Carnival  
Clubhouse**

**⚠ WARNING:** Not suitable for children under 36 months. Fall Hazard.  
Only for domestic use.

To be used under the direct supervision of an adult. Intended for children ages 3-12.

This owner's manual contains important information about how to assemble, locate, use, and maintain this playground equipment. Read this manual before you start assembly. Follow all instructions. Be sure to educate all children who use this playground and all adult supervisors about the rules for safe use that are contained in this manual.

Keep this Owner's Manual for future reference and to remind you of how to safely use and maintain this equipment.

**RAINBOW RESERVES THE RIGHT TO MAKE CHANGES AND MODIFICATIONS TO THIS PRODUCT.**

**COPYRIGHT 2017 RAINBOW PLAY SYSTEMS, INC. ALL RIGHTS RESERVED**

# ***OWNER'S MANUAL***

## **Rainbow Play Systems, Inc.**

Thank you for choosing Rainbow Play Systems, Inc. Please read the instruction manual thoroughly before you start building your Carnival Clubhouse to help ensure safe installation. Familiarize yourself with all hardware and parts to help with building your playground.

***WARNING: Failure to follow the assembly, location, use, and maintenance instructions in this manual could result in serious injury to children using this playground.***

<i>Rules for Safe Play.....</i>	<i>2</i>
<i>Choosing Location of Play System.....</i>	<i>3</i>
<i>Choosing Proper Surface Material.....</i>	<i>3-4</i>
<i>Maintenance.....</i>	<i>4</i>
<i>Helpful Tips.....</i>	<i>5</i>
<i>Commonly Asked Questions.....</i>	<i>6</i>
<i>Hardware.....</i>	<i>7-10</i>
<i>Tool Required for Assembly.....</i>	<i>10</i>
<i>Parts Identification.....</i>	<i>11-36</i>
<i>Instructions.....</i>	<i>36-130</i>
<i>Warranty.....</i>	<i>131</i>

Thoroughly read all Safety Instructions on pages 2-5 before beginning assembly of your playset.

# Welcome to RAINBOW

Welcome to our family of ready-to-build residential play equipment. Ease of assembly has been pre-engineered into our product and we provide step-by-step installation instructions.

To ensure safe play for your children, before building your play system, please take some time with your children and go over the **Rules for safe play on your play system**. Do not allow children in the area while you are assembling your play system. Many of Rainbow's components are very heavy and could seriously injure a child. Observing these rules reduces the likelihood of serious or fatal injury.

**After thoroughly reading the information below, locate your play site and carefully unpack parts.** As you unpack your play system, keep the parts list handy and become familiar with each part before beginning assembly. Remember that a little extra time spent familiarizing yourself with the parts and the instructions before you begin will help to avoid mistakes and save you time later. Please keep these instructions for future reference.

This product is recommended for children 3 to 12 years of age.

**Note: This product is not intended for public use. Rainbow Play Systems, Inc. does not warranty its Residential Play Equipment subject to commercial use.**

## Safety Instructions

### Rules for Safe Play

***WARNING: Before allowing children to play on this equipment for the first time, carefully review the rules for safe play with them. Observing the following statements and warnings reduces the likelihood of a serious or fatal injury.***

1. **IT IS RECOMMENDED** that no more than 8-10 children, not exceeding a combined weight of 1,500 pounds, play on the system at one time. This product is recommended for children 3 to 12 years of age.
2. **CLOSE ADULT SUPERVISION** is required for children of all ages.
3. **WARN CHILDREN TO AVOID** playing or walking in front of, behind, or between moving equipment.
4. **WARN CHILDREN NOT TO** twist swing chains or ropes, or to loop them over the top support bar since this may reduce the strength of the chain or rope.
5. **INSTRUCT CHILDREN NOT TO** swing empty seats, trapeze bar, gliders, buoy balls or tire swings.
6. **INSTRUCT CHILDREN** to always sit, never stand or kneel, in the center of the swing seat with their full weight.
7. **INSTRUCT CHILDREN NOT TO** use any part of the play system in a manner other than what it is intended.
8. **INSTRUCT CHILDREN NOT TO** get off equipment while it is in motion.
9. **DRESS CHILDREN APPROPRIATELY. CHILDREN SHOULD NOT** wear scarves, hats with straps, helmets, jackets with draw strings, hooded jackets, poorly fitting shoes, or any other loose fitting clothing that is potentially hazardous while using equipment.
10. **INSTRUCT CHILDREN NOT TO** play on the equipment if it is wet. Potentially slippery surfaces may cause a hazard.
11. **VERIFY** all suspended items such as ropes and chains are secure at both ends.
12. **VERIFY** all suspended items such as climbing ropes are tight so they cannot be looped back on themselves.
13. **INSTRUCT CHILDREN NOT TO** attach items to the play system not specifically intended for use with the play equipment. Items such as, but not limited to, jump ropes, clotheslines, pet leashes, cables and chain may pose a strangulation hazard.
14. **INSTRUCT CHILDREN TO REMOVE** any bike or other sports helmets before playing on the play equipment, as they may pose a possible hanging hazard. Children must be dressed appropriately.
15. **INSTRUCT CHILDREN** there may only be one person on a swing at a time with a maximum weight of 150 pounds per swing.
16. **VERIFY** there are no gaps between the slide bed way and the slide screws.
17. **INSTRUCT CHILDREN** to always go down slides feet first. Never slide head first.
18. **INSTRUCT CHILDREN TO NEVER** climb, crawl, or walk on items not intended for such use. Such types of play on top of Monkey Bars, Fort Roof, and Swing Beams greatly increase the risk of a serious or fatal fall.
19. **INSTRUCT CHILDREN** that only one child can be on Wave Slide at a time with a maximum weight of 140 pounds.

## Choosing a location for your play system

When selecting your play site, always keep the child's safety in mind. Here are some recommendations that should help you achieve a safe play area.

1. The play system should be located on solid level ground free of objects that could cause injury such as, but not limited to, tree stumps, roots, and large rocks. Stationary components such as ladders and slides must be no less than SIX FEET (1.8 meters) from any structure or obstruction such as a fence, garage, house, tree or overhanging branches, electrical wires or clotheslines. Any swinging equipment must be a minimum distance of TWICE the height of the swing beam away from any structures or obstructions as specified above. We also recommend that you do not install your play system near a lake, river, swimming pool or other water hazards.
2. If anchoring your play system, all underground utilities must be located in play zone before starting assembly of play system.
3. Try to locate slide out of direct sunlight to reduce the likelihood of serious burns. A slide that faces north will receive the least direct sunlight.
4. It is recommended not to place a set on sandy soil or loose fill as it may require additional anchoring in that situation.
5. Do not install your play system over concrete, asphalt, packed earth, grass, carpet, or any other hard surface. A fall onto a hard surface can result in serious injury to the play system user.

Set Dimensions	Play Zone
L 20' 3" x W 16' 5" x H 11' 7"	L 32' 3" x W 32' 2"

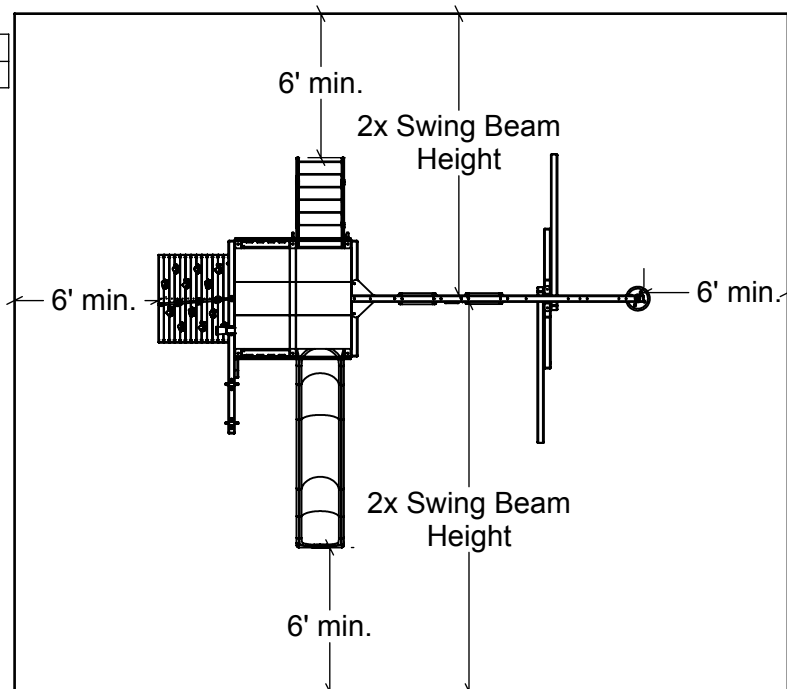

## Choosing a surfacing material

The consumer shall provide playground surfacing materials under and around residential play equipment that conforms to the recommendations of the Consumer Product Safety Commission's Outdoor Home Playground Safety Handbook publications #324. A copy of the section relating to surfacing materials is included in the installation instructions. Free copies of this handbook are available on line at [www.cpsc.gov](http://www.cpsc.gov) or by contacting the CPSC Publications Office in Washington D.C. 20207.

The URL is <http://www.cpsc.gov/cpsc/pub/pubs/324.pdf> and the file size is 456.5KB

Playground equipment should never be placed on hard surfaces such as concrete or asphalt. Do not use loose fill surfacing on top of hard surfaces such as concrete or asphalt. While grass may appear to be acceptable, it may quickly turn to hard packed earth in areas of high traffic. Shredded bark mulch, wood chips, fine sand or fine gravel are considered to be acceptable shock absorbing surfaces when installed and maintained at a sufficient depth under and around playground equipment. The U.S. Product Safety Commission (CPSC) estimates that about 100,000 playground equipment-related injuries resulting from falls to the ground surface are treated annually in U.S. hospital's emergency rooms. Injuries involving this hazard pattern tend to be the most serious of all playground injuries, and have a potential to be fatal, particularly when the injury is to the head. The surface under and around playground equipment can be a major factor in determining the injury-causing potential of a fall. It is self evident that a fall onto a shock absorbing surface is less likely to cause a serious injury than a fall onto a hard surface.

The following information is intended to assist in comparing the relative shock-absorbing properties of various materials. No particular material is recommended over another. However, each material is only effective when properly maintained. Materials should be checked periodically and replenished to maintain correct depth as determined necessary for your equipment. The choice of a material depends on the type and height of your playground equipment, the availability of the material in your area, and its cost.

Table 3.1 lists the maximum height from which a child would not be expected to sustain a life-threatening head injury in a fall onto four different loose-fill surfacing materials if they are installed and maintained at depths of 6, 9, and 12 inches. However, it should be recognized that all injuries due to falls cannot be prevented no matter what surfacing material is used.

Type of Material	6 in. depth	9 in. depth	12 in. depth
Double Shredded Bark Mulch	6 ft.	10 ft.	11 ft.
Wood Chips	6 ft.	7 ft.	12 ft.
Fine Sand	5 ft.	5 ft.	9 ft.
Fine Gravel	6 ft.	7 ft.	10 ft.

Equipment Fall Height	1'	2'	3'	4'	5'	6'	7'	8'	9'	10'	11'	12'
Wood Chips	6"	6"	6"	6"	6"	6"	6 1/2"	7 1/2"	8 1/4"	9"	12"	13"
Double Shredded Bark Mulch	6"	6"	6"	6"	7"	8"	9"	9 3/4"	10 1/2"	11 1/2"	12"	13"
Engineered Wood Fibers	6"	6"	6"	7"	8 1/2"	9"	9 1/2"	10 1/4"	10 3/4"	11"	10 3/4"	12"
Fine Sand	6"	6"	6 1/2"	8"	9"	10"	10 1/2"	11 1/4"	12"	13 1/2"	14 3/4"	16"
Coarse Sand	6"	6"	7 1/2"	9"	10 1/2"	12"	14"	16"	18"	20"	22"	24"
Fine Gravel	6"	6"	6"	6 3/4"	8"	9"	10"	10 3/4"	11 1/2"	12"	13 1/4"	14 1/2"
Medium Gravel	6"	6 1/4"	8"	9"	9"	12"	14"	16"	18"	20"	22"	24"

Chart obtained from U.S. Consumer Product Safety Commission Handbook for Public Playground Safety

**NOTICE:** It is recommended to use containment, such as digging out around the perimeter and/or lining the perimeter with landscape edging for surfacing materials.

Installations of rubber tiles or poured-in-place surfaces (other than loose-fill materials) generally require a professional and are not "do-it-yourself" projects.

When surfacing is to be used it is recommended to use Playground Surfacing Materials (other than loose-fill materials) which comply to the safety standard ASTM 1292 Standard Specification for Impact Attenuation of Surfacing Materials within the Use Zone of Playground Equipment.

## Maintenance of your play system

To ensure safe enjoyment of your Rainbow Play System for years to come, follow these maintenance tips:

- At the beginning of each usage season and twice each month**, check and tighten as needed (but do not over tighten causing the wood to crack) all nuts and bolts. Acorn nuts should be tightened to 5 foot pounds of torque. Hardware used on swinging elements should be checked at least twice a month to ensure proper fastening.
- At the beginning of each usage season and twice each month**, check all coverings for bolts and sharp edges to be certain they are in place. Replace when necessary.
- Oil all** metallic moving parts and grease Tire Swivel monthly during the usage period.
- Check** all moving parts including swing seats, ropes, and chains for wear, rust, or other deterioration and replace as needed.
- Check** all metal parts for rust. If needed, sand and repaint using a nonlead-based paint meeting the requirements of Title 16 CFR Part 1303.
- Check** the S-Hooks on the chains to ensure the gap is less than .040 inches. Tighten/close as necessary.
- Remove** plastic swing seats and take indoors or do not use when temperature drops below 32° Fahrenheit. Reinstall swing seats when the cold season is complete.
- Check, twice a month**, the depth of loose fill protective surfacing materials to prevent compaction and to maintain appropriate depth. Rake or replace as necessary.
- When you are ready to dispose of your playset**, make sure all metal, plastic and wood components are disposed of in accordance with local waste ordinances and ensure that no unreasonable hazards exist.
- On a yearly basis**, we recommend that you coat your play system with a sealant or preservative. You may also want to spot sand areas before sealing. Be sure that the sealant you select is non-toxic and child safe.
- Check** all wood members for deterioration and splinters. Spot sand any areas that are checking or splintering. If parts are deteriorating, replace as needed.

## Helpful Installation Hints

1. **Wear safety glasses to protect your eyes from flying wood chips when drilling or cutting.**
2. **Verify that all bolts and screws are secured tightly and all acorn nuts are snug** (acorn nuts should be tightened to 5 foot pounds of torque).
3. **DO NOT** allow children to play on the play system until it is completely assembled in a proper location.
4. **DO NOT** allow children in the area while you are assembling your play system. Many of the Rainbow Play Systems, Inc. components are very heavy and could seriously injure a child.
5. **After thoroughly reading all information and properly locating your play system site, carefully unpack parts.** As you unpack your play system, keep the parts list handy and become familiar with each part before beginning assembly. Remember that a little extra time spent familiarizing yourself with the parts and instructions before you begin will help avoid mistakes and save you time later.
6. **Group** both wood and non-wood parts together in accordance to each page, or Step, of this assembly manual. Doing this now will help you quickly locate parts and assemble the set with ease.
7. **Sort** your hardware into groups of similar hardware pieces. Use a solid surface, such as the empty boxes, to ensure you do not lose any hardware.
8. **Before** starting each Step, thoroughly read all of the instructions to ensure all information is understood. Pay special attention to the orientation of each part, details & notes, and proper usage of hardware. Each piece of hardware is required for a certain part of the assembly.
9. **Certain** steps of the assembly are best performed on a hard flat surface to ensure proper and accurate assembly.
10. **All Lag Bolts** must have pre-drilled holes 2" deep (as shown in Detail A). Use a 1/8" drill bit for all 1/4" and 5/16" Lag Bolts and use a 1/4" drill bit for all 3/8" Lag Bolts. Lag Bolts can be difficult to put in knot holes. Pre-drilling pilot holes will help to prevent the Lag Bolts from breaking.
11. **All #14 Phillips Pan Head Tap Screws** must have pre-drilled holes 1/2" deep. Use a 1/8" drill bit.
12. **Use** a clamp to secure facias flush to the Uprights and use holes in fascia as a guide for placing Lag Bolt Pilot Holes (as shown in Detail B).
13. **Verify** Facias are flush with Uprights.
14. **Check** assembly periodically to ensure the set is level and all facias are square to the uprights.
15. If a gap occurs between boards when inserting Screws or Lag Bolts, back out hardware and apply pressure to the top board while reinserting hardware in the same hole.

### WARNING

Drilling, sawing, sanding or machining wood products generates wood dust, a substance known to the State of California to cause cancer. Avoid inhaling wood dust or use a dust mask or other safeguards for personal protection.

California Health and Safety Code Section 25249.6

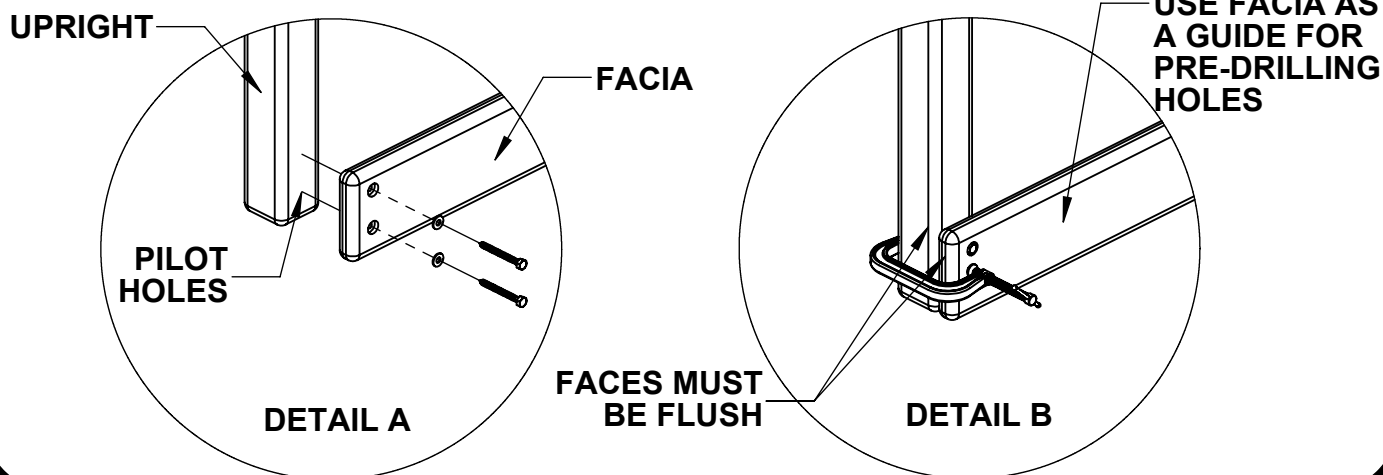

# COMMONLY ASKED QUESTIONS

Question: How do I know when Lag Bolts and other Fasteners are tightened properly?

Answer: Lag Bolts and other Fasteners are tight when the head of the Lag Bolt and Washer are firmly compressed against the wood. If splintering occurs, that is an indication you are over tightening the Lag Bolts and other Fasteners. (Splintering is when the wood fibers fracture out from under the washers).

Question: What should I do if a Lag Bolt or other Fastener lines up with a knot, or if the Lag Bolt breaks?

Answer: There is extra Hardware provided with the set for this reason. Re-Drill a new hole with a 1/8" Drill Bit in a new direction to miss the obstruction.

Question: What if my Play System is leaning and/or rocks?

Answer: This is caused by unlevelled ground under the Base and Support Wings of the Play System. It may be necessary to remove or add some soil beneath the Play System to make it level. Ground Stakes, when installed, will also provide stability.

Question: What if my Play System has cracks on the wood or seems to be developing cracks?

Answer: Seasonal checks, surface cracks, and knot holes are natural characteristics of all wooden play equipment. A check is a separation of the wood fibers running with the grain. This is caused by varying temperature and moisture conditions. By coating your Play System annually with a sealant or preservative, you can help protect your Play System from developing (not stopping) seasonal checks. Please remember to follow all installation instructions, including installing the play set on solid level ground.

Question: What is the sticky substance that appears on the wood?

Answer: The sticky substance that may appear on the wood is called pitch. It is common for the lumber to have occasional pitch seepage which does not affect the structural integrity of the part. Pitch provides the natural rot resistant characteristics of the lumber. If play surfaces or play items become overly sticky with pitch use rubbing alcohol to safely remove.

Question: What accessories may be added or what modifications can be made to my Rainbow boxed kit set?

Answer: Rainbow boxed kit sets are complete kits and are not modular. Play sets with unauthorized accessories or modifications will not be covered under warranty. Non-residential use of the play set voids warranty.

Question: Is my child old enough to use all play items on my set?

Answer: All play items on Rainbow boxed kit sets are designed for children ages 3 to 12, but it is the end users responsibility to determine suitability of use by their children for each play item.

**EXAMPLE OF SEASONAL CHECKS OR SURFACE CRACKS**

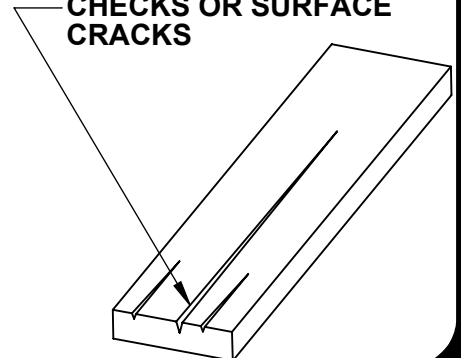

**Hardware for Assembly**  
**Note: Thread length may vary from what is pictured.**

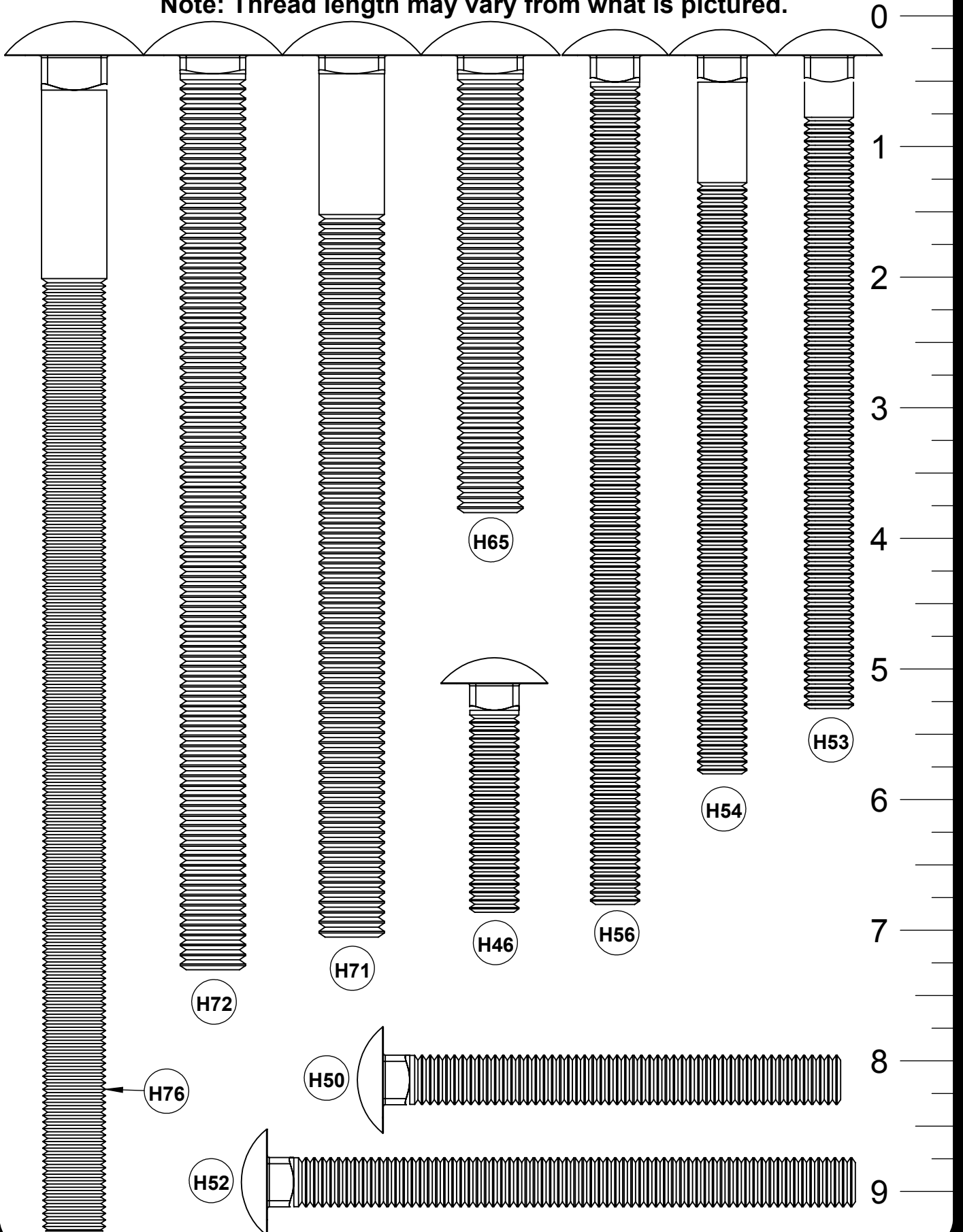



# Hardware for Assembly

Note: Thread length may vary from what is pictured.

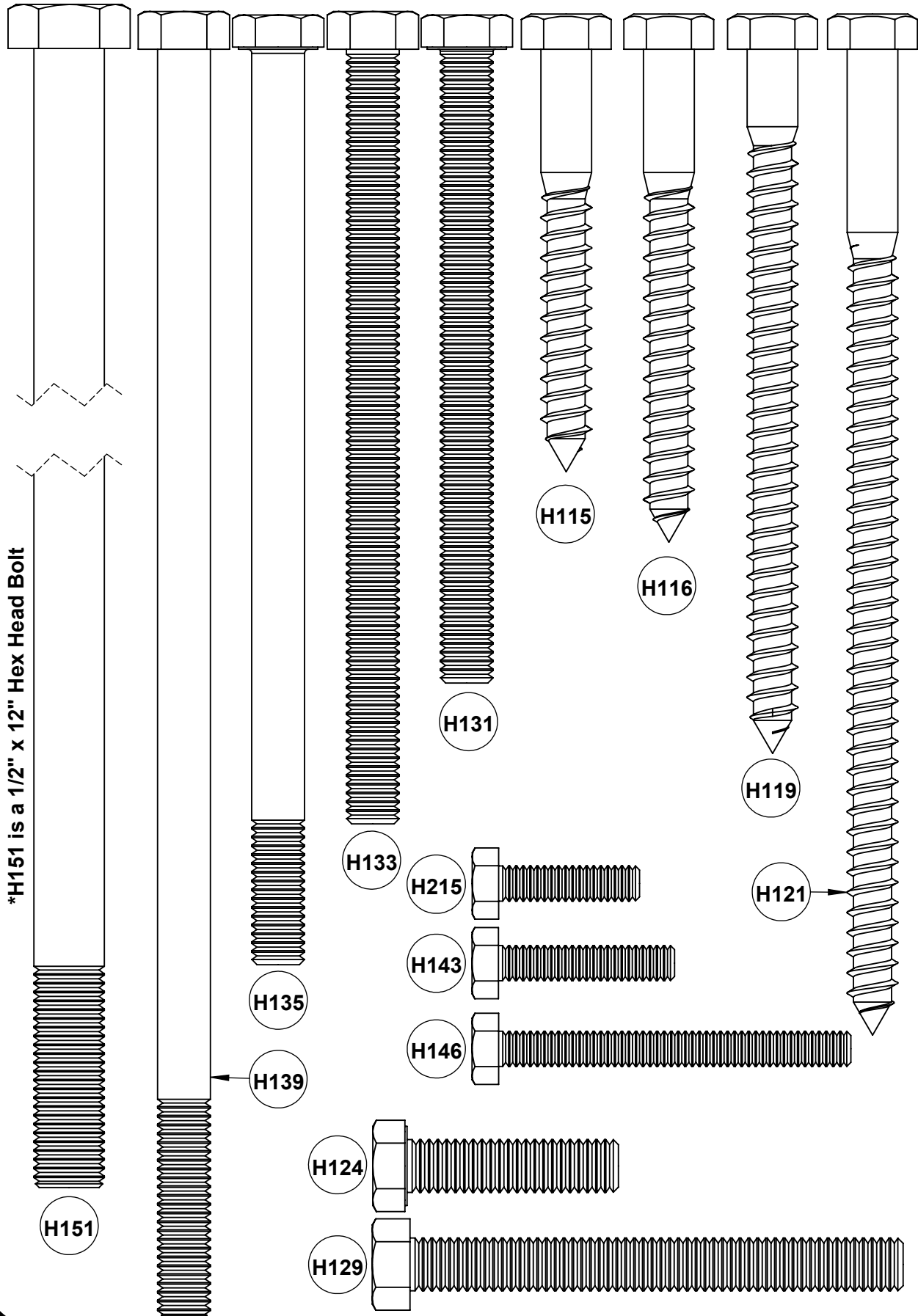

# Hardware for Assembly

\*Note: Thread length may vary from what is pictured.

0  
1  
2  
3  
4  
5  
6  
7  
8  
9

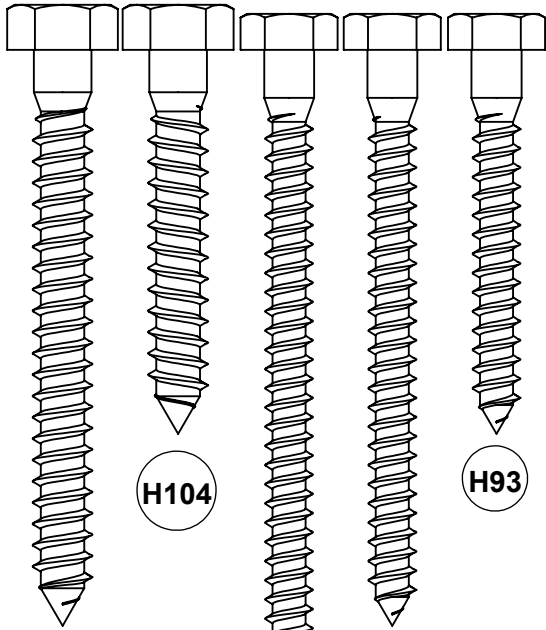

H108

H104

H93

H97

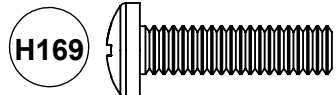

H169

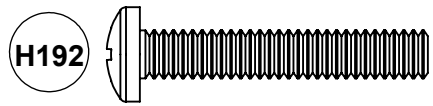

H192

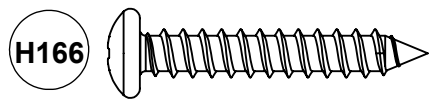

H166

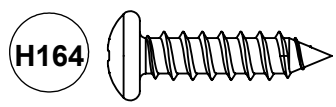

H164

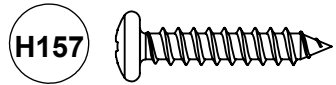

H157

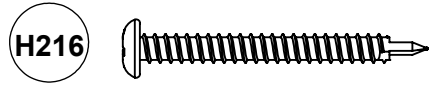

H216

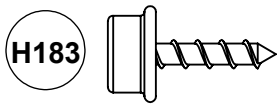

H183

H188



H100



H155

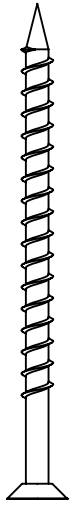

H154



H153

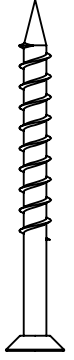

H152

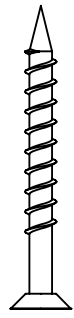

H194

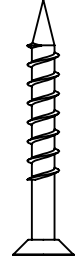

H32

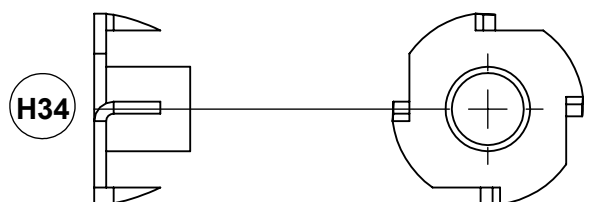

H34

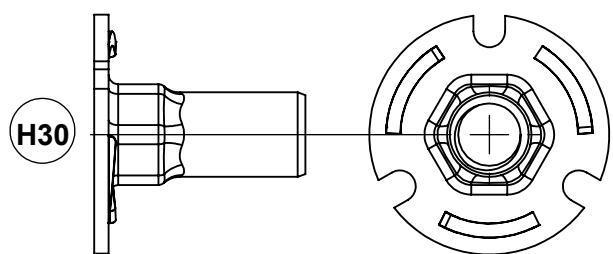

H30

## Hardware for Assembly

**\*Note: Thread length may vary from what is pictured.**

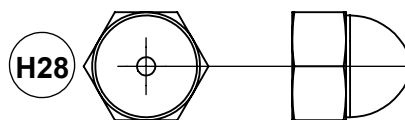
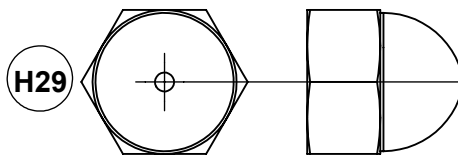
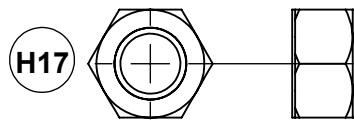
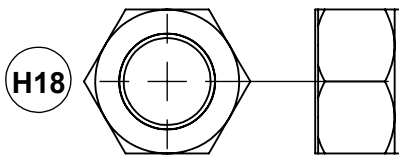
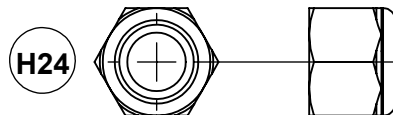
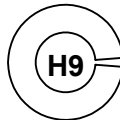
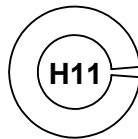
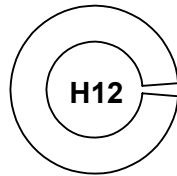
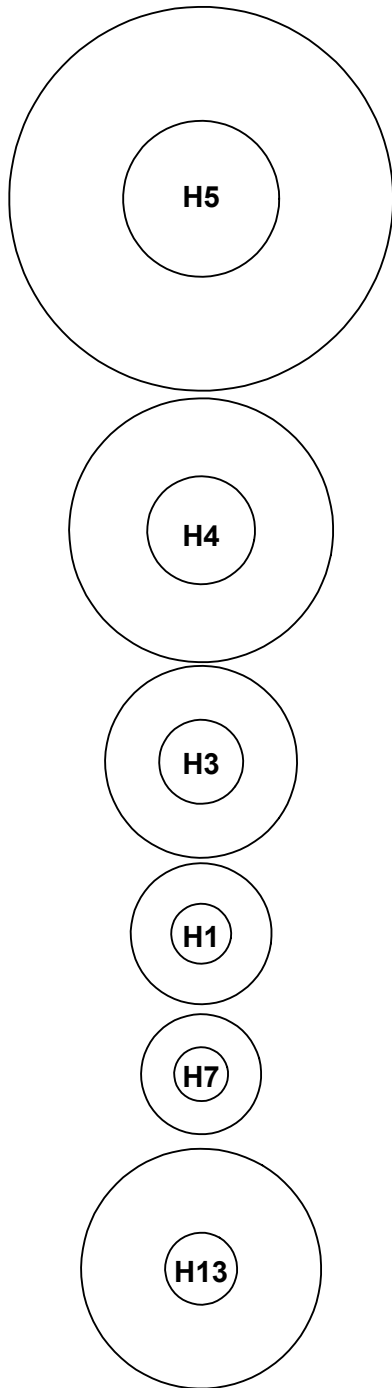

0  
1  
2  
3  
4  
5  
6  
7  
8  
9

## TOOLS REQUIRED FOR ASSEMBLY

Tape Measure  
Carpenters Level  
Carpenters Square  
Rubber Mallet (optional)  
Claw Hammer  
Wood Clamp  
Standard or Cordless Drill  
with #2 & #3 Phillips Bits

Electric Impact Gun or 1/4"  
and 3/8" Ratchet  
1/8" Drill Bit  
1/4" Drill Bit  
9/16" Drill Bit  
Torque Wrench  
Crescent Wrench

7/16" Deep Well Socket  
1/2" Deep Well Socket  
9/16" Deep Well Socket  
9/16" Box Wrench  
8' Step Ladder  
Safety Glasses  
Adult Helper

## Carnival Clubhouse Hardware List

<u>F/N#</u>	<u>DESCRIPTION</u>	<u>DIMENSION</u>	<u>QTY</u>	<u>FOUND IN</u>
H1	Flat Washer	1/4"	54	5-46-0892
H3	Flat Washer	3/8"	20	5-46-0892
H4	Flat Washer	1/2"	8	5-46-0892
H7	SAE Flat Washer	1/4"	2	5-46-0892
H11	Lock Washer	3/8"	8	5-46-0892
H17	Standard Nut	3/8"	8	5-46-0892
H28	Acorn Nut	3/8"	8	5-46-0892
H54	Carriage Bolt	3/8" x 5 1/2"	4	5-46-0892
H56	Carriage Bolt	3/8" x 6 1/2"	4	5-46-0892
H93	Lag Bolt	1/4" x 2"	6	5-46-0892
H104	Lag Bolt	5/16" x 2"	4	5-46-0892
H108	Lag Bolt	5/16" x 3"	54	5-46-0892
H115	Lag Bolt	3/8" x 3"	4	5-46-0892
H116	Lag Bolt	3/8" x 3 1/2"	8	5-46-0892
H152	Phillips Wood Screw	#8 x 1 1/2"	96	5-46-0892
H154	Phillips Wood Screw	#8 x 2"	89	5-46-0892
H155	Phillips Wood Screw	#8 x 2 1/2"	24	5-46-0892
H157	Phillips Pan Head Tap Screw	#10 x 1"	8	5-46-0892
H164	Phillips Pan Head Tap Screw	#14 x 1"	18	5-46-0892
H166	Phillips Pan Head Tap Screw	#14 x 1 1/2"	4	5-46-0892

**\*NOTE: Extra Hardware is included in the bags. Not all Hardware will be used to complete the installation.**

## Carnival Clubhouse Base Parts List

**3294**



1 @ 2 x 4 x 57" DECK RUNNER (3-03-0294)

**4132**

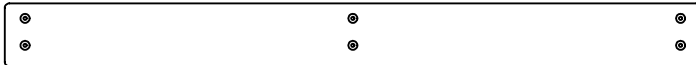

2 @ 2 x 6 x 58" 6 HOLE FACIA (3-04-0132)

**4133**

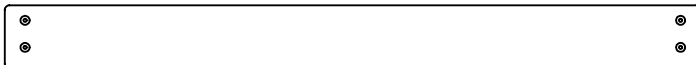

4 @ 2 x 6 x 58" 4 HOLE FACIA (3-04-0133)

**6108**



3 @ 4 x 4 x 19" LEFT SLIM BRACKET  
(3-06-0108)

**6107**

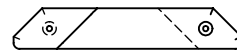

3 @ 4 x 4 x 19" RIGHT SLIM BRACKET (3-06-0107)

**6303**

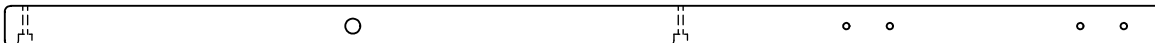

1 @ 4 x 4 x 96 1/2" ACCESSORY ARM (3-06-0303)

**6304**

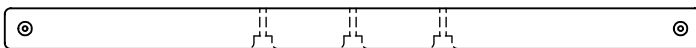

1 @ 4 x 4 x 58" TOP JOIST W/ SWING HOLES (3-06-0304)

**7058**

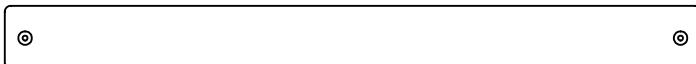

2 @ 4 x 6 x 58" MAIN BEAM (3-07-0058)

## Carnival Clubhouse Base Parts List Continued

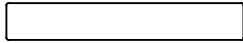
9219   
1 @ 5/4 x 4 x 21" SLIDE FILLER  
BLOCK (3-09-0219)

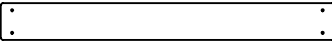
9222   
24 @ 5/4 x 4 x 29 1/2" RAIL UPRIGHT (3-09-0222)

9223   
2 @ 5/4 x 4 x 30 5/8" CORNER FACIA (3-09-0223)

9229   
2 @ 5/4 x 4 x 51 1/4" SHORT DECK BOARD (3-09-0229)

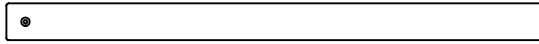
9233   
2 @ 5/4 x 4 x 58" 2 HOLE FACIA (3-09-0233)

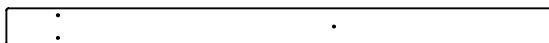
9232   
14 @ 5/4 x 4 x 58" DECK BOARD (3-09-0232)

0129   
1 @ 5/4 x 6 x 58" DECK BOARD (3-10-0129)

0128   
3 @ 5/4 x 6 x 58" 4 HOLE FACIA (3-10-0128)

## Carnival Clubhouse Corner Upright

6302   
4 @ 4 x 4 x 109" CORNER UPRIGHT W/ TJ HOLES (3-06-0302)

## Turbo Carnival Clubhouse Corner Upright

6324   
4 @ 4 x 4 x 113" CORNER UPRIGHT W/ TJ HOLES (3-06-0324)

## Carnival Clubhouse Base Non-Wood Parts List

N391   
2 @ SAFETY HANDLE  
(5-31-0121)

N113   
2 @ LADDER HANDLE  
(5-33-0070)

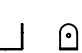
N8   
4 @ SMALL 90°  
BRACKET (5-35-0089)

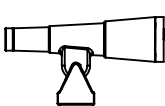
N19   
1 @ TELESCOPE  
(5-41-0020)

N20   
1 @ SHIP'S WHEEL  
(5-41-0021)

N83   
1 @ RAINBOW PLAQUE  
(5-42-0028)

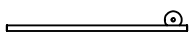
N28   
6 @ GROUND STAKE  
(5-47-0033)

N73   
1 @ STEP LADDER  
BRACKET  
(5-35-0039)

## Carnival Clubhouse Tarp Option Parts List

6138

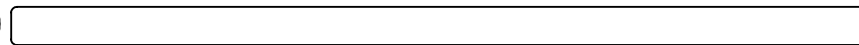

2 @ 4 x 4 x 75 3/4" CENTER POST (3-06-0138)

9233

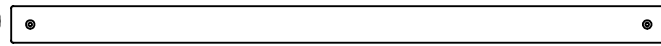

3 @ 5/4 x 4 x 58" 2 HOLE FACIA (3-09-0233)

N352

1 @ Carnival Clubhouse Tarp  
(5-22-0284) (5-22-0285)

**\*Not Shown:**

## Carnival Clubhouse Step Ladder Parts List

4135

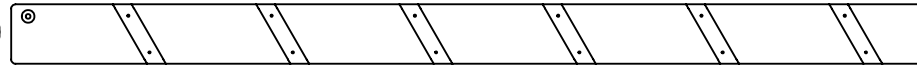

1 @ 2 x 6 x 81" LEFT LADDER LEG (3-04-0135)

4134

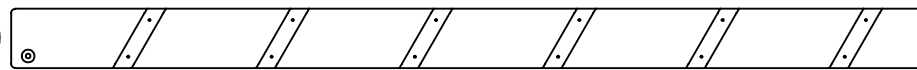

1 @ 2 x 6 x 81" RIGHT LADDER LEG (3-04-0134)

0131



1 @ 5/4 x 6 x 24" LADDER ENTRAPMENT BOARD (3-10-0131)

4006



6 @ 2 x 8 x 22 1/4" LADDER STEP (3-14-0006)

## Turbo Carnival Clubhouse Step Ladder Parts List

4153



1 @ 2 x 6 x 85 1/2" LEFT LADDER LEG (3-04-0153)

4152

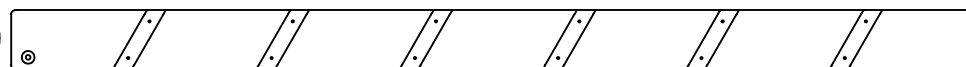

1 @ 2 x 6 x 85 1/2" RIGHT LADDER LEG (3-04-0152)

0131



1 @ 5/4 x 6 x 24" LADDER ENTRAPMENT BOARD (3-10-0131)

4006

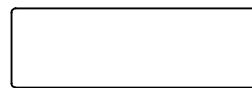

6 @ 2 x 8 x 22 1/4" LADDER STEP (3-14-0006)

## Carnival Clubhouse Sandbox Add-On Hardware List

F/N#	DESCRIPTION	DIMENSION	QTY	FOUND IN
H108	Lag Bolt	5/16" x 3	16	5-46-0896
H1	Flat Washer	1/4"	16	5-46-0896

## Carnival Clubhouse Sandbox Add-On Parts List

4133

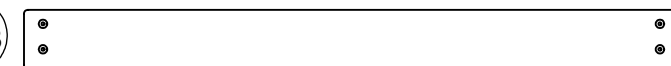

4 @ 2 x 6 x 58" 4 HOLE FACIA (3-04-0133)

# Carnival Clubhouse Picnic Table Parts List

<u>F/N#</u>	<u>DESCRIPTION</u>	<u>DIMENSION</u>	<u>QTY</u>	<u>FOUND IN</u>
H1	Flat Washer	1/4"	12	5-46-0894
H108	Lag Bolt	5/16" x 3"	12	5-46-0894
H154	Phillips Wood Screw	#8 x 2"	75	5-46-0894

**3293**

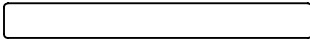

1 @ 2 x 4 x 28 7/8" TABLE RUNNER (3-03-0293)

**3297**

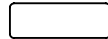

2 @ 2 x 4 x 9 3/8" SEAT RUNNER (3-03-0297)

**9230**

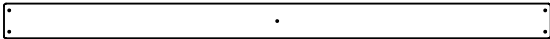

2 @ 5/4 x 4 x 51 1/4" SHORT PICNIC BOARD (3-09-0230)

**9231**

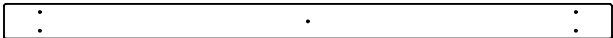

13 @ 5/4 x 4 x 57" PICNIC BOARD (3-09-0231)

**0128**

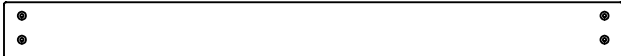

3 @ 5/4 x 6 x 58" 4 HOLE FACIA (3-10-0128)

## Box Kit Chalkboard Parts List

<u>F/N#</u>	<u>DESCRIPTION</u>	<u>DIMENSION</u>	<u>QTY</u>	<u>FOUND IN</u>
H155	Phillips Wood Screw	#8 x 2 1/2"	4	5-46-0830
H152	Phillips Wood Screw	#8 x 1 1/2"	14	5-46-0830

**3160**

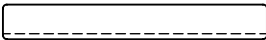

2 @ 2 x 4 x 24 3/4" CHALKBOARD SIDE  
(1-03-1160)

**3161**



2 @ 2 x 4 x 15 3/8" CHALKBOARD TOP/BOTTOM  
(1-03-1161)

**2174**

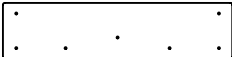

2 @ 1 x 6 x 21 1/2" CHALKBOARD RUNNER  
(1-02-0174)

\*NOT SHOWN  
**N181** 1 @ RAINBOW CHALKBOARD  
(5-44-0019)

## Box Kit Tic Tac Toe Parts List

<u>F/N#</u>	<u>DESCRIPTION</u>	<u>DIMENSION</u>	<u>QTY</u>	<u>FOUND IN</u>
H154	Phillips Wood Screw	#8 x 2"	4	5-46-0829

**4055**

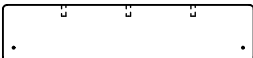

2 @ 2 x 6 x 23 1/2" TTT TOP/BOTTOM BOARD (1-04-1055)

\*NOT SHOWN  
**N172 N173** 1 @ TTT - NO MOUNTING  
**N174** PANEL  
(5-41-0048)

## Box Kit Bubble Window Parts List

<u>F/N#</u>	<u>DESCRIPTION</u>	<u>DIMENSION</u>	<u>QTY</u>	<u>FOUND IN</u>
H154	Phillips Wood Screw	#8 x 2"	4	5-46-0888
H153	Phillips Wood Screw	#8 x 1 3/4"	12	5-46-0888
H152	Phillips Wood Screw	#8 x 1 1/2"	8	5-46-0888

**3214**

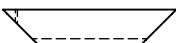

4 @ 2 x 4 x 16 1/4" BUBBLE  
WINDOW FRAME  
(1-03-1214)

**0171**

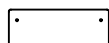

4 @ 5/4 x 6 x 9 3/8" BUBBLE  
WINDOW UPRIGHT  
(1-10-0171)

**N168**

\*NOT SHOWN  
1 @ SMALL BUBBLE  
WINDOW  
(5-42-0062)

# Carnival Clubhouse Rock Wall Parts List

<u>F/N#</u>	<u>DESCRIPTION</u>	<u>DIMENSION</u>	<u>QTY</u>	<u>FOUND IN</u>
H1	Flat Washer	1/4"	2	5-46-0893
H7	SAE Flat Washer	1/4"	56	5-46-0893
H11	Lock Washer	3/8"	2	5-46-0893
H32	4 Prong T-Nut	1/4"	28	5-46-0893
H34	4 Prong T-Nut	3/8"	2	5-46-0893
H56	Carriage Bolt	3/8" x 6 1/2"	2	5-46-0893
H108	Lag Bolt	5/16" x 3"	2	5-46-0893
H124	Hex Head Bolt	3/8" x 1 1/2"	2	5-46-0893
H154	Phillips Wood Screw	#8 x 2"	72	5-46-0893
H164	Phillips Pan Head Screw	#14 x 1"	10	5-46-0893
H169	Phillips Pan Head Machine Screw	1/4" x 1"	4	5-46-0893
H192	Phillips Pan Head Machine Screw	1/4" x 1 1/2"	24	5-46-0893

**3295**

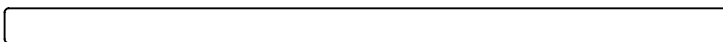

1 @ 2 x 4 x 68" ROCK WALL RUNNER (3-03-0295)

**3296**



2 @ 2 x 4 x 70 1/4" ROCK WALL LEG (3-03-0296)

**9168**

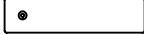

2 @ 5/4 x 4 x 13 1/8" CORNER FACIA  
(3-09-0168)

**9221**

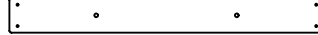

2 @ 5/4 x 4 x 29 1/2" RAIL UPRIGHT W/ HANDLE  
HOLES (3-09-0221)

**9224**

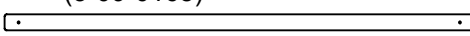

1 @ 5/4 x 4 x 44" ROCK WALL TOP BOARD  
(3-09-0224)

**0134**



6 @ 5/4 x 6 x 44" 2 HOLE INSIDE ROCK  
WALL BOARD (3-10-0134)

**0135**



6 @ 5/4 x 6 x 44" 2 HOLE OUTSIDE ROCK WALL  
BOARD (3-10-0135)

**0136**



1 @ 5/4 x 6 x 44" ROCK WALL BOARD  
WITH ROPE HOLE (3-10-0136)

**0145**



1 @ 5/4 x 6 x 58" ROCK WALL MOUNTING FACIA  
(3-10-0145)

**N156**

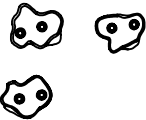

12 @ ROCKS  
(5-42-0068) (5-42-0069)

**N391**

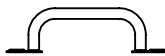

2 @ SAFETY HANDLE  
(5-33-0121)

**N9**



2 @ 90° BRACKET  
(5-35-0090)

**N8**



2 @ SMALL 90°  
BRACKET  
(5-35-0089)

**N60**

**\*NOT SHOWN:**  
1 @ 13 1/2' ROPE  
(5-20-0297)



# Turbo Carnival Clubhouse Rock Wall Parts List

<u>F/N#</u>	<u>DESCRIPTION</u>	<u>DIMENSION</u>	<u>QTY</u>	<u>FOUND IN</u>
H1	Flat Washer	1/4"	2	5-46-0893
H7	SAE Flat Washer	1/4"	56	5-46-0893
H11	Lock Washer	3/8"	2	5-46-0893
H32	4 Prong T-Nut	1/4"	28	5-46-0893
H34	4 Prong T-Nut	3/8"	2	5-46-0893
H56	Carriage Bolt	3/8" x 6 1/2"	2	5-46-0893
H108	Lag Bolt	5/16" x 3"	2	5-46-0893
H124	Hex Head Bolt	3/8" x 1 1/2"	2	5-46-0893
H154	Phillips Wood Screw	#8 x 2"	72	5-46-0893
H164	Phillips Pan Head Screw	#14 x 1"	10	5-46-0893
H169	Phillips Pan Head Machine Screw	1/4" x 1"	4	5-46-0893
H192	Phillips Pan Head Machine Screw	1/4" x 1 1/2"	24	5-46-0893

**3217**

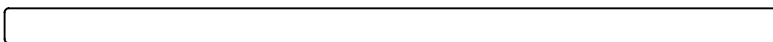

1 @ 2 x 4 x 73" ROCK WALL RUNNER (3-03-0217)

**3318**

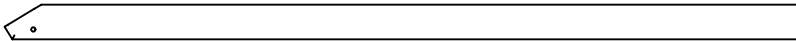

2 @ 2 x 4 x 74 7/8" ROCK WALL LEG (3-03-0318)

**9168**

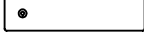

2 @ 5/4 x 4 x 13 1/8" CORNER FACIA  
(3-09-0168)

**9221**

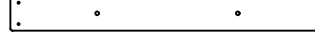

2 @ 5/4 x 4 x 29 1/2" RAIL UPRIGHT W/ HANDLE  
HOLES (3-09-0221)

**9224**

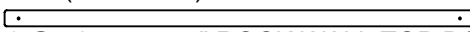

1 @ 5/4 x 4 x 44" ROCK WALL TOP BOARD  
(3-09-0224)

**0134**



6 @ 5/4 x 6 x 44" 2 HOLE INSIDE ROCK  
WALL BOARD (3-10-0134)

**0135**



6 @ 5/4 x 6 x 44" 2 HOLE OUTSIDE ROCK WALL  
BOARD (3-10-0135)

**0136**



1 @ 5/4 x 6 x 44" ROCK WALL BOARD  
WITH ROPE HOLE (3-10-0136)

**0145**



1 @ 5/4 x 6 x 58" ROCK WALL MOUNTING FACIA  
(3-10-0145)

**0141**



1 @ 5/4 x 6 x 44" ROCK WALL BOARD (3-10-0141)

**N156**

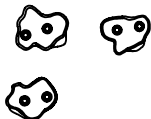

12 @ ROCKS  
(5-42-0068) (5-42-0069)

**N391**



2 @ SAFETY HANDLE  
(5-33-0121)

**N9**



2 @ 90° BRACKET  
(5-35-0090)

**N8**



2 @ SMALL 90°  
BRACKET  
(5-35-0089)

**N60**

**\*NOT SHOWN:**  
1 @ 13 1/2' ROPE  
(5-20-0297)

# Carnival Clubhouse Wood Roof Parts List

<u>F/N#</u>	<u>DESCRIPTION</u>	<u>DIMENSION</u>	<u>QTY</u>	<u>FOUND IN</u>
H3	Flat Washer	3/8"	4	5-46-0898
H11	Lock Washer	3/8"	4	5-46-0898
H34	4 Prong T-Nut	3/8"	4	5-46-0898
H131	Hex Head Bolt	3/8" x 4 1/2"	4	5-46-0898
H154	Phillips Wood Screw	#8 x 2"	84	5-46-0898
H152	Phillips Wood Screw	#8 x 1 1/2"	20	5-46-0898
H194	Phillips Wood Screw	#8 x 1 1/4"	24	5-46-0898

**1228**  2 @ 1 x 4 x 17" FAN VERTICAL (3-01-0228)

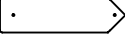
**1229**  4 @ 1 x 4 x 11 3/4" FAN RAY (3-01-0229)

**1231**  2 @ 1 x 4 x 40 5/8" FAN HORIZONTAL (3-01-0231)

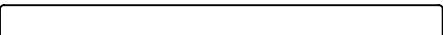
**3158**  2 @ 2 x 4 x 41 1/2" ROOF RUNNER (3-03-0158)

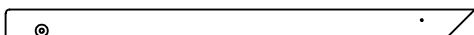
**3304**  2 @ 2 x 4 x 44" LEFT ROOF SUPPORT (3-03-0304)

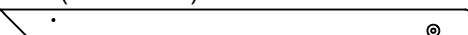
**3305**  2 @ 2 x 4 x 44" RIGHT ROOF SUPPORT (3-03-0305)

**4144**  20 @ 2 x 6 x 62 5/8" ROOF BOARD (3-04-0144)

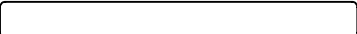
**6313**  2 @ 4 x 4 x 33 1/2" SHORT CENTER POST (3-06-0313)

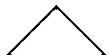
**0080**  1 @ 5/4 x 6 x 9 1/2" PEAK FACIA (3-10-0080)

**0081**  1 @ 5/4 x 6 x 9" FAN CENTER (3-10-0081)

# Carnival Clubhouse Cabin Package Parts List

<u>F/N#</u>	<u>DESCRIPTION</u>	<u>DIMENSION</u>	<u>QTY</u>	<u>FOUND IN</u>
H1	Flat Washer	1/4"	4	5-46-0899
H9	Lock Washer	1/4"	2	5-46-0899
H32	4 Prong T-Nut	1/4"	2	5-46-0899
H108	Lag Bolt	5/16" x 3"	4	5-46-0899
H143	Hex Head Bolt	1/4" x 1 1/4"	2	5-46-0899
H152	Phillips Wood Screw	#8 x 1 1/2"	196	5-46-0899
H155	Phillips Wood Screw	#8 x 2 1/2"	8	5-46-0899
H194	Phillips Wood Screw	#8 x 1 1/4"	32	5-46-0899

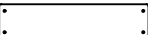
**1272**  8 @ 1 x 4 x 14" CABIN UPRIGHT (3-01-0272)

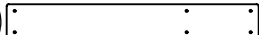
**1273**  2 @ 1 x 4 x 23 5/8" CABIN UPRIGHT (3-01-0273)

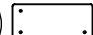
**1274**  4 @ 1 x 4 x 7 1/2" 3 HOLE CABIN UPRIGHT (3-01-0274)

**2070**  4 @ 1 x 6 x 24 5/8" CABIN UPRIGHT (3-02-0070)

**2071**  4 @ 1 x 6 x 26" ANGLED CABIN UPRIGHT (3-02-0071)

**1245**  12 @ 1 x 4 x 7 1/2" CABIN UPRIGHT (3-01-0245)

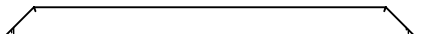
**3186**  2 @ 2 x 4 x 39 1/2" ANGLED CABIN FACIA (3-03-0186)

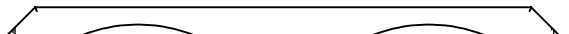
**3187**  2 @ 2 x 4 x 53" ARCHED ANGLED CABIN FACIA (3-03-0187)

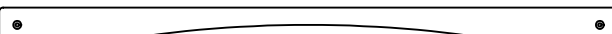
**3331**  2 @ 2 x 4 x 58" ARCHED CABIN FACIA (3-03-0331)

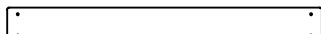
**9222**  3 @ 5/4 x 4 x 29 1/2" RAIL UPRIGHT (3-09-0222)

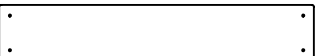
**0132**  8 @ 5/4 x 6 x 29 1/2" RAIL UPRIGHT (3-10-0132)

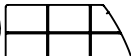
**0149**  4 @ 5/4 x 6 x 11 7/8" LEFT SHUTTER BOARD (3-10-0149)

**0150**  4 @ 5/4 x 6 x 11 7/8" RIGHT SHUTTER BOARD (3-10-0150)

# Carnival Club Lower Level Playhouse Parts List

<u>F/N#</u>	<u>DESCRIPTION</u>	<u>DIMENSION</u>	<u>QTY</u>	<u>FOUND IN</u>
H1	Flat Washer	1/4"	31	5-46-0900
H56	Carriage Bolt	3/8" x 6 1/2"	4	5-46-0900
H108	Lag Bolt	5/16" x 3"	31	5-46-0900
H164	Phillips Pan Head Screw	#14 x 1"	2	5-46-0900
H154	Phillips Wood Screw	#8 x 2"	60	5-46-0900
H155	Phillips Wood Screw	#8 x 2 1/2"	12	5-46-0900
H194	Phillips Wood Screw	#8 x 1 1/4"	440	5-46-0900

**1267**   
 3 @ 1 x 4 x 54 1/4" PLAYHOUSE UPRIGHT  
 (3-01-0267)

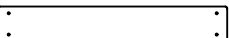
**1275**   
 28 @ 1 x 4 x 21 1/2" PLAYHOUSE UPRIGHT  
 (3-01-0275)

**2072**   
 3 @ 1 x 6 x 54 1/4" NOTCHED PLAYHOUSE  
 UPRIGHT (3-02-0072)

**2073**   
 11 @ 1 x 6 x 54 1/4" PLAYHOUSE UPRIGHT  
 (3-02-0073)

**3197**   
 1 @ 2 x 4 x 58" FLOOR RUNNER (3-03-0197)

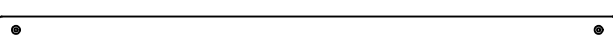
**3330**   
 2 @ 2 x 4 x 58" FLOOR SUPPORT (3-03-0330)

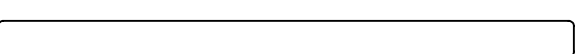
**6323**   
 1 @ 4 x 4 x 54" PLAYHOUSE DOOR UPRIGHT  
 (3-06-0323)

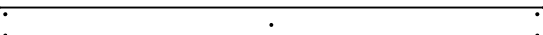
**9181**   
 2 @ 5/4 x 4 x 51 1/4" DECK/FLOOR BOARD  
 (3-09-0181)

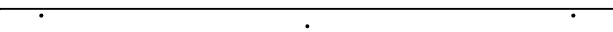
**9182**   
 1 @ 5/4 x 4 x 58" DECK/FLOOR BOARD (3-09-0182)

**9237**   
 3 @ 5/4 x 4 x 58" ARCHED PLAYHOUSE FACIA  
 (3-09-0237)

**9233**   
 6 @ 5/4 x 4 x 58" 2 HOLE FACIA (3-09-0233)

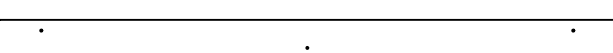
**0092**   
 9 @ 5/4 x 6 x 58" DECK/FLOOR BOARD (3-10-0092)

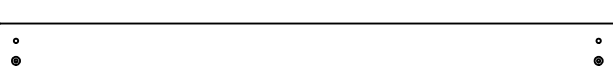
**0145**   
 1 @ 5/4 x 6 x 58" ROCK WALL MOUNTING FACIA  
 (3-10-0145)

**1268**   
 28 @ 1 x 4 x 14 7/8" PLAYHOUSE UPRIGHT  
 (3-01-0268)

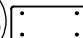
**1276**   
 4 @ 1 x 4 x 7 1/8" SHORT PLAYHOUSE  
 UPRIGHT (3-01-0276)

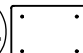
**2074**   
 1 @ 1 x 6 x 7 1/8" SHORT PLAYHOUSE  
 UPRIGHT (3-02-0074)

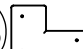
**2075**   
 1 @ 1 x 6 x 7 1/8" SHORT NOTCHED  
 PLYHS UPRIGHT (3-02-0075)

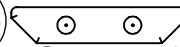
**6170**   
 4 @ 4 x 4 x 16 1/2" FLOWER BOX  
 (3-06-0170)

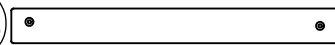
**9223**   
 2 @ 5/4 x 4 x 30 5/8" CORNER FACIA  
 (3-09-0223)

**9238**   
 1 @ 5/4 x 4 x 30 5/8" ARCHED PLAYHOUSE  
 WINDOW FACIA (3-09-0238)

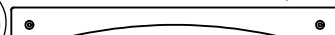
**9239**   
 1 @ 5/4 x 4 x 30 5/8" ARCHED PLAYHOUSE  
 DOOR FACIA (3-09-0239)

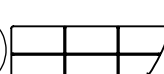
**0091**   
 7 @ 5/4 x 6 x 15" RIGHT SHUTTER  
 (3-10-0091)

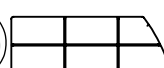
**0090**   
 7 @ 5/4 x 6 x 15" LEFT SHUTTER  
 (3-10-0090)

**N8** 

1 @ SMALL 90° BRACKET  
 (5-35-0089)

# Turbo Carnival Clubhouse Lower Level Playhouse Add-On Parts List

<u>F/N#</u>	<u>DESCRIPTION</u>	<u>DIMENSION</u>	<u>QTY</u>	<u>FOUND IN</u>
H1	Flat Washer	1/4"	8	5-46-0901
H108	Lag Bolt	5/16" x 3"	8	5-46-0901

**2073**   
3 @ 1 x 6 x 54 1/4" PLAYHOUSE UPRIGHT (3-02-0073)

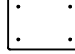
**2074**   
1 @ 1 x 6 x 7 1/8" SHORT PLAYHOUSE UPRIGHT (3-02-0074)

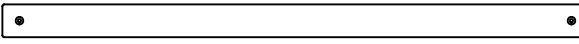
**9233**   
4 @ 5/4 x 4 x 58" 2 HOLE FACIA (3-09-0233)

## Carnival Clubhouse Ramp Parts List

<u>F/N#</u>	<u>DESCRIPTION</u>	<u>DIMENSION</u>	<u>QTY</u>	<u>FOUND IN</u>
H52	Carriage Bolt	3/8" x 4 1/2"	2	5-46-0877
H119	Lag Bolt	3/8" x 5"	3	5-46-0877
H116	Lag Bolt	3/8" x 3 1/2"	2	5-46-0877
H164	Phillips Pan Head Tap Screw	#14 x 1"	2	5-46-0877
H155	Phillips Wood Screw	#8 x 2 1/2"	70	5-46-0877
H4	Flat Washer	1/2"	2	5-46-0877
H3	Flat Washer	3/8"	5	5-46-0877
H11	Lock Washer	3/8"	2	5-46-0877
H17	Standard Nut	3/8"	2	5-46-0877
H28	Acorn Nut	3/8"	2	5-46-0877

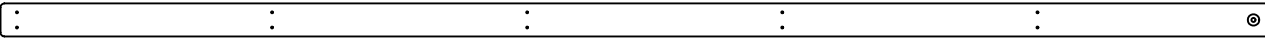
**3324**   
2 @ 2 x 4 x 126" RAMP RAIL (3-03-0324)

**3325**   
5 @ 2 x 4 x 21" RAMP CLEAT (3-03-0325)

**3326**   
1 @ 2 x 4 x 23 3/4" FILLER BOARD (3-03-0326)

**4158**   
2 @ 2 x 6 x 118 1/4" RAMP BOARD W/HOLE (3-04-0158)

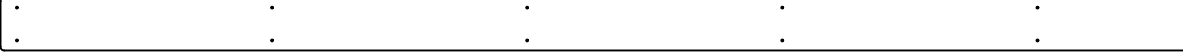
**4159**   
2 @ 2 x 6 x 118 1/4" RAMP BOARD (3-04-0159)

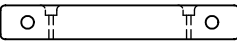
**6343**   
1 @ 4 x 4 x 23 5/8" RAMP ROPE BLOCK (3-06-0343)

**N8**   
1 @ SMALL 90° BRACKET (5-35-0089)

**\*NOT SHOWN**  
**N59** 2 @ 17 1/2' ROPE (5-20-0021)

## CARNIVAL CLUBHOUSE RAMP UPRIGHT PARTS LIST

**6051**   
1 @ 4 x 4 x 32" CARNIVAL RAMP UPRIGHT (1-06-1051)

# Carnival 4x4 Monkey Bar Parts List

<u>F/N#</u>	<u>DESCRIPTION</u>	<u>DIMENSION</u>	<u>QTY</u>	<u>FOUND IN</u>
H3	Flat Washer	3/8"	15	5-46-0902
H4	Flat Washer	1/2"	4	5-46-0902
H5	Flat Washer	3/4"	2	5-46-0902
H11	Lock Washer	3/8"	2	5-46-0902
H12	Lock Washer	1/2"	2	5-46-0902
H17	Standard Nut	3/8"	2	5-46-0902
H18	Standard Nut	1/2"	2	5-46-0902
H28	Acorn Nut	3/8"	2	5-46-0902
H29	Acorn Nut	1/2"	2	5-46-0902
H71	Carriage Bolt	1/2" x 6 3/4"	2	5-46-0902
H56	Carriage Bolt	3/8" x 6 1/2"	2	5-46-0902
H104	Lag Bolt	5/16" x 2"	4	5-46-0695
H116	Lag Bolt	3/8" x 3 1/2"	8	5-46-0902
H119	Lag Bolt	3/8" x 5"	4	5-46-0902
H139	Hex Head Bolt	3/8" x 9"	1	5-46-0902
H216	Phillips Pan Head Self Drilling Screw	#8 x 1 1/2"	22	5-46-0902



1 @ 4 x 4 x 80" LEFT MONKEY BAR ARM (3-06-0316)



1 @ 4 x 4 x 80" RIGHT MONKEY BAR ARM (3-06-0317)

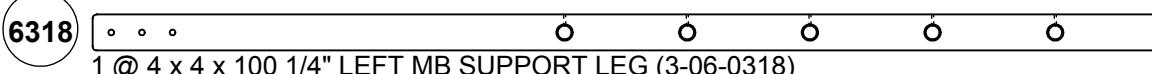

1 @ 4 x 4 x 100 1/4" LEFT MB SUPPORT LEG (3-06-0318)



1 @ 4 x 4 x 100 1/4" RIGHT MB SUPPORT LEG (3-06-0319)

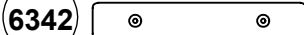

2 @ 4 x 4 x 20" MONKEY BAR SUPPORT BLOCK (3-06-0342)

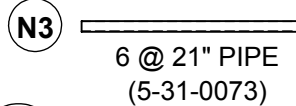

6 @ 21" PIPE (5-31-0073)

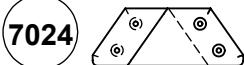

1 @ 4 x 6 x 14 1/8" RIGHT MONKEY BAR BRACKET(3-07-0024)

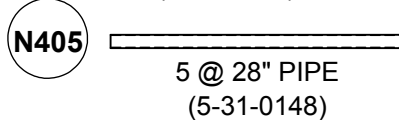

5 @ 28" PIPE (5-31-0148)



1 @ 4 x 6 x 14 1/8" LEFT MONKEY BAR BRACKET (3-07-0025)



2 @ SAFETY HANDLE (5-33-0121)

# Carnival 4x6 Monkey Bar Parts List

<u>F/N#</u>	<u>DESCRIPTION</u>	<u>DIMENSION</u>	<u>QTY</u>	<u>FOUND IN</u>
H3	Standard Nut	3/8"	4	5-46-0903
H7	Acorn Nut	3/8"	4	5-46-0903
H74	Carriage Bolt	3/8" x 6 1/2"	4	5-46-0903
H104	Lag Bolt	5/16" x 2"	4	5-46-0695
H116	Lag Bolt	3/8" x 3 1/2"	8	5-46-0903
H119	Lag Bolt	3/8" x 5"	6	5-46-0903
H124	Hex Head Bolt	3/8" x 9"	1	5-46-0903
H155	Lock Washer	3/8"	4	5-46-0903
H164	Flat Washer	3/8"	19	5-46-0903
H166	Flat Washer	1/2"	4	5-46-0903
H192	Phillips Wood Screw	#8 x 3 1/2"	20	5-46-0903
H216	Phillips Pan Head Self Drilling Screw	#8 x 1 1/2"	12	5-46-0903

**6147**

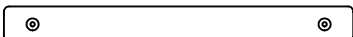

1 @ 4 x 4 x 32 3/4" MONKEY BAR GROUND RUNNER (3-06-0147)

**6342**

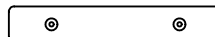

2 @ 4 x 4 x 20" MONKEY BAR SUPPORT BLOCK (3-06-0342)

**7024**

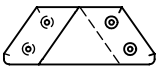

1 @ 4 x 6 x 14 1/8" RIGHT MONKEY BAR BRACKET (3-07-0024)

**7025**

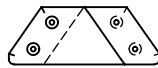

1 @ 4 x 6 x 14 1/8" LEFT MONKEY BAR BRACKET (3-07-0025)

**7051**



1 @ 4 x 6 x 87" LEFT MONKEY BAR ARM (3-07-0051)

**7052**



1 @ 4 x 6 x 87" RIGHT MONKEY BAR ARM (3-07-0052)

**7053**

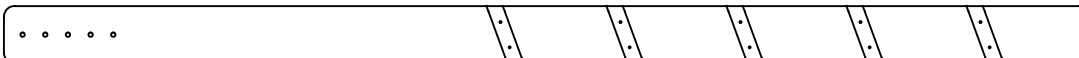

1 @ 4 x 6 x 101 3/4" LEFT MB SUPPORT LEG (3-07-0053)

**7054**

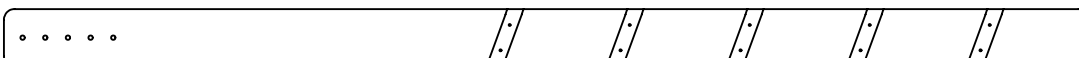

1 @ 4 x 6 x 101 3/4" RIGHT MB SUPPORT LEG (3-07-0054)

**4007**

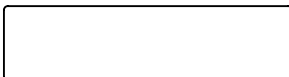

5 @ 2 x 8 x 27" LADDER STEP (3-14-0007)

**N3**

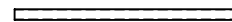

6 @ 21" PIPE (5-31-0073)

**N6**

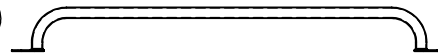

2 @ LADDER HANDLE (5-33-0103)

# Carnival Penthouse Parts List

<u>F/N#</u>	<u>DESCRIPTION</u>	<u>DIMENSION</u>	<u>QTY</u>	<u>FOUND IN</u>
H1	Flat Washer	1/4"	56	5-46-0906
H3	Flat Washer	3/8"	20	5-46-0906
H9	Lock Washer	1/4"	3	5-46-0906
H32	4 Prong T-Nut	1/4"	3	5-46-0906
H97	Lag Bolt	1/4" x 3"	54	5-46-0906
H104	Lag Bolt	5/16" x 2"	4	5-46-0906
H116	Lag Bolt	3/8" x 3 1/2"	2	5-46-0906
H119	Lag Bolt	3/8" x 5"	14	5-46-0906
H121	Lag Bolt	3/8" x 7"	4	5-46-0906
H146	Hex Head Bolt	1/4" x 2 1/2"	2	5-46-0906
H215	Hex Head Bolt	1/4" x 1"	1	5-46-0906
H154	Phillips Wood Screw	#8 x 2"	80	5-46-0906
H164	Phillips Pan Head Tap Screw	#14 x 1"	18	5-46-0906

**3175**

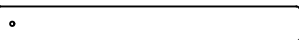

2 @ 2 x 4 x 28 1/2" SHORT PENTHOUSE CENTER POST (3-03-0175)

**3180**

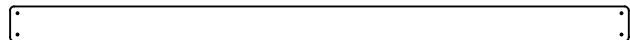

1 @ 2 x 4 x 58" TARP BOARD (3-03-0180)

**3181**



2 @ 2 x 4 x 58" PENTHOUSE SIDE BOARD (3-03-0181)

**4066**

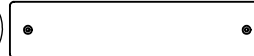

1 @ 2 x 6 x 23 7/8" MONKEY BAR ENTRAPMENT BOARD (3-04-0066)

**4069**

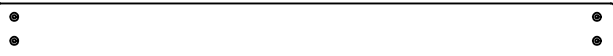

8 @ 2 x 6 x 58" PENTHOUSE SIDE BOARD (3-04-0069)

**4147**

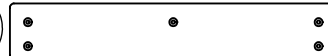

2 @ 2 x 6 x 30 5/8" TARP FACIA (3-04-0147)

**4150**



1 @ 2 x 6 x 30 5/8" PENTHOUSE END FACIA (3-04-0150)

**6320**

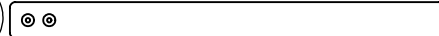

3 @ 4 x 4 x 40 3/4" PENTHOUSE CORNER POST (3-06-0320)

**6321**

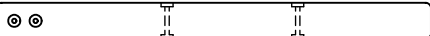

1 @ 4 x 4 x 40 3/4" PENTHOUSE CORNER POST (3-06-0321)

**6344**

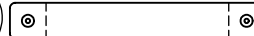

1 @ 4 x 4 x 23 7/8" STEP BLOCK (3-06-0344)

**7055**

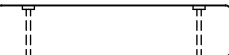

1 @ 4 x 6 x 22" FILLER BLOCK (3-07-0055)

**7056**

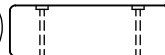

1 @ 4 x 6 x 15" FILLER BLOCK (3-07-0056)

**9243**

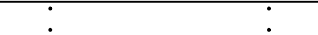

1 @ 5/4 x 4 x 30 5/8" DECK BOARD (3-09-0243)

**9244**

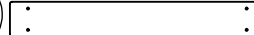

3 @ 5/4 x 4 x 23 7/8" SHORT DECK BOARD (3-09-0244)

**9245**



4 @ 5/4 x 4 x 30" PENTHOUSE RAIL UPRIGHT (3-09-0245)

**0146**



1 @ 5/4 x 6 x 23 7/8" SHORT DECK BOARD (3-10-0146)

**0147**

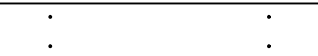

9 @ 5/4 x 6 x 30 5/8" DECK BOARD (3-10-0147)

**N376**

1 @ CARNIVAL PENTHOUSE TARP (5-22-0278, 5-22-0279)

\*NOT SHOWN:

**N391**

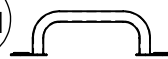

2 @ SAFETY HANDLE (5-33-0121)

**N33**

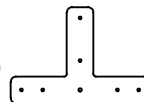

2 @ T-BRACKET (5-35-0087)

# Carnival Penthouse w/ Spiral Opening Parts List

<u>F/N#</u>	<u>DESCRIPTION</u>	<u>DIMENSION</u>	<u>QTY</u>	<u>FOUND IN</u>
H1	Flat Washer	1/4"	56	5-46-0906
H3	Flat Washer	3/8"	20	5-46-0906
H9	Lock Washer	1/4"	3	5-46-0906
H32	4 Prong T-Nut	1/4"	3	5-46-0906
H97	Lag Bolt	1/4" x 3"	54	5-46-0906
H104	Lag Bolt	5/16" x 2"	4	5-46-0906
H116	Lag Bolt	3/8" x 3 1/2"	2	5-46-0906
H119	Lag Bolt	3/8" x 5"	14	5-46-0906
H121	Lag Bolt	3/8" x 7"	4	5-46-0906
H146	Hex Head Bolt	1/4" x 2 1/2"	2	5-46-0906
H215	Hex Head Bolt	1/4" x 1"	1	5-46-0906
H154	Phillips Wood Screw	#8 x 2"	80	5-46-0906
H164	Phillips Pan Head Tap Screw	#14 x 1"	18	5-46-0906

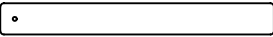
**3175**   
2 @ 2 x 4 x 28 1/2" SHORT PENTHOUSE  
CENTER POST (3-03-0175)

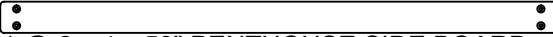
**3181**   
1 @ 2 x 4 x 58" PENTHOUSE SIDE BOARD  
(3-03-0181)

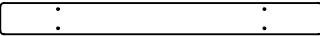
**3328**   
2 @ 2 x 4 x 33 1/2" MID RANGE SPIRAL  
FILLER BOARD (3-03-0328)

**4066**   
1 @ 2 x 6 x 23 7/8" MONKEY BAR  
ENTRAPMENT BOARD (3-04-0066)

**4069**   
5 @ 2 x 6 x 58" PENTHOUSE SIDE BOARD  
(3-04-0069)

**4160**   
3 @ 2 x 6 x 27" SHORT PENTHOUSE  
SIDE BOARD (3-04-0160)

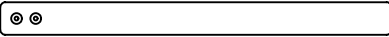
**6320**   
3 @ 4 x 4 x 40 3/4" PENTHOUSE CORNER  
POST (3-06-0320)

**6344**   
1 @ 4 x 4 x 23 7/8" STEP BLOCK (3-06-0344)

**7056**   
1 @ 4 x 6 x 15" FILLER BLOCK (3-07-0056)

**7060**   
1 @ 4 x 6 x 27 5/8" MID RANGE SPIRAL  
FILLER BLOCK (3-07-0060)

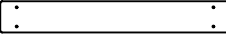
**9244**   
3 @ 5/4 x 4 x 23 7/8" SHORT DECK BOARD  
(3-09-0244)

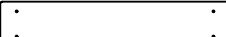
**0146**   
1 @ 5/4 x 6 x 23 7/8" SHORT DECK BOARD  
(3-10-0146)

**3180**   
1 @ 2 x 4 x 58" TARP BOARD (3-03-0180)

**3327**   
1 @ 2 x 4 x 27" SHORT PENTHOUSE SIDE BOARD  
(3-03-0327)

**3329**   
1 @ 2 x 4 x 24 1/4" MID RANGE SPIRAL FILLER  
(3-03-0329)

**4147**   
2 @ 2 x 6 x 30 5/8" TARP FACIA (3-04-0147)

**4150**   
1 @ 2 x 6 x 30 5/8" PENTHOUSE END FACIA  
(3-04-0150)

**4161**   
1 @ 2 x 6 x 24 1/4" MID RANGE SPIRAL  
FILLER (3-04-0161)

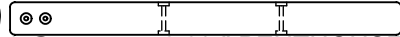
**6321**   
1 @ 4 x 4 x 40 3/4" PENTHOUSE CORNER POST  
(3-06-0321)

**7055**   
1 @ 4 x 6 x 22" FILLER BLOCK (3-07-0055)

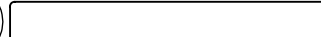
**7059**   
1 @ 4 x 6 x 33" PENTHOUSE SPIRAL UPRIGHT  
(3-07-0059)

**9243**   
1 @ 5/4 x 4 x 30 5/8" DECK BOARD (3-09-0243)

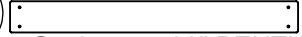
**9245**   
4 @ 5/4 x 4 x 30" PENTHOUSE RAIL UPRIGHT  
(3-09-0245)

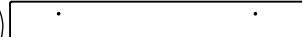
**0147**   
9 @ 5/4 x 6 x 30 5/8" DECK BOARD (3-10-0147)



# Carnival PENT w/ Spiral Opening Parts List Continued

**\*NOT SHOWN:**  
**N377** 1 @ CARNIVAL PENTHOUSE  
 SPIRAL TARP  
 (5-22-0280) (5-22-0281)

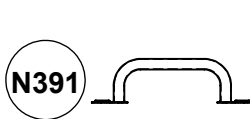

**N391**  
 2 @ SAFETY HANDLE  
 (5-33-0121)

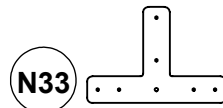

**N33**  
 2 @ T-BRACKET  
 (5-35-0087)



**N8**  
 3 @ SMALL 90°  
 BRACKET  
 (5-35-0089)

## Carnival Penthouse Wood Roof Parts List

<u>F/N#</u>	<u>DESCRIPTION</u>	<u>DIMENSION</u>	<u>QTY</u>	<u>FOUND IN</u>
H215	Hex Head Bolt	1/4" x 1"	2	5-46-0908
H100	Lag Bolt	1/4" x 4 1/2"	4	5-46-0908
H97	Lag Bolt	1/4" x 3"	4	5-46-0908
H154	Phillips Wood Screw	#8 x 2"	78	5-46-0908
H1	Flat Washer	1/4"	8	5-46-0908

**3182**   
 2 @ 2 x 4 x 28" ROOF RUNNER  
 (3-03-0182)

**3183**   
 4 @ 2 x 4 x 29 3/4" PENTHOUSE WOOD ROOF  
 SUPPORT (3-03-0183)

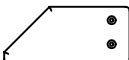
**4164**   
 1 @ 2 x 6 x 11 3/4" PENTHOUSE WOOD  
 ROOF FILLER (3-04-0164)

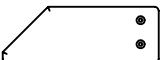
**4070**   
 1 @ 2 x 6 x 14 5/8" PENTHOUSE WR FILLER  
 (3-04-0070)

**4162**   
 12 @ 2 x 6 x 58" ROOF BOARD (3-04-0162)

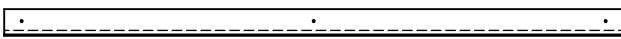
**4163**   
 2 @ 2 x 6 x 58" PENTHOUSE FILLER ROOF BOARD (3-04-0163)

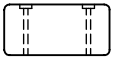
**7061**   
 1 @ 4 x 6 x 9 7/8" SHORT FILLER BLOCK  
 (3-07-0061)

**9183**   
 1 @ 5/4 x 4 x 26 1/2" ENTRAPMENT BOARD (3-09-0183)

**0087**   
 2 @ 5/4 x 6 x 8 3/8" PEAK FACIA (3-10-0087)

## 10' Wave Slide Parts List

<u>F/N#</u>	<u>DESCRIPTION</u>	<u>DIMENSION</u>	<u>QTY</u>	<u>FOUND IN</u>
H164	Phillips Pan Head Tap Screw	#14 x 1"	4	5-46-0446
H7	SAE Flat Washer	1/4"	4	5-46-0446

**N24**

**\*NOT SHOWN:**  
1 @ 10' WAVE SLIDE  
5-44-0139, 5-44-0140

## 10' Wave Slide Block Parts List

<u>F/N#</u>	<u>DESCRIPTION</u>	<u>DIMENSION</u>	<u>QTY</u>	<u>FOUND IN</u>
H119	Lag Bolt	3/8" x 5"	4	5-46-0239
H3	Flat Washer	3/8"	4	5-46-0239

**7678**

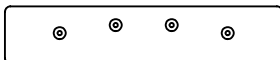

1 @ 4 x 6 x 26" 10' WAVE SLIDE BLOCK (1-07-0678)

## 10.5' Wave Slide Parts List

<u>F/N#</u>	<u>DESCRIPTION</u>	<u>DIMENSION</u>	<u>QTY</u>	<u>FOUND IN</u>
H166	Phillips Pan Head Tap Screw	#14 x 1 1/2"	4	5-46-0920
H7	SAE Flat Washer	1/4"	4	5-46-0920

**N404**

**\*NOT SHOWN:**  
1 @ 10.5' WAVE SLIDE  
5-44-0281, 5-44-0282

## 10.5' Wave Slide Block Parts List

<u>F/N#</u>	<u>DESCRIPTION</u>	<u>DIMENSION</u>	<u>QTY</u>	<u>FOUND IN</u>
H119	Lag Bolt	3/8" x 5"	4	5-46-0239
H3	Flat Washer	3/8"	4	5-46-0239

**7867**

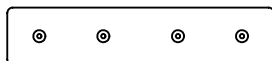

1 @ 4 x 6 x 25" 10.5' WAVE SLIDE BLOCK (1-07-0867)

## Grab N Go Parts List

<u>F/N#</u>	<u>DESCRIPTION</u>	<u>DIMENSION</u>	<u>QTY</u>	<u>FOUND IN</u>
H14	Fender Washer	3/8" x 1 1/4"	4	5-46-0695
H104	Lag Bolt	5/16" x 2"	4	5-46-0695
N407	Grab N Go Bar		1	Part # - 5-33-0129

## 10' Scoop Slide Parts List

<u>F/N#</u>	<u>DESCRIPTION</u>	<u>DIMENSION</u>	<u>QTY</u>	<u>FOUND IN</u>
H3	Flat Washer	3/8"	22	5-46-0784
H4	Flat Washer	1/2"	8	5-46-0784
H11	Lock Washer	3/8"	14	5-46-0784
H17	Standard Nut	3/8"	6	5-46-0784
H21	Jam Nut	3/8"	8	5-46-0784
H28	Acorn Nut	3/8"	14	5-46-0784
H50	Carriage Bolt	3/8" x 3 1/2"	4	5-46-0784
H53	Carriage Bolt	3/8" x 5"	2	5-46-0784
H116	Lag Bolt	3/8" x 3 1/2"	4	5-46-0784
H119	Lag Bolt	3/8" x 5"	4	5-46-0239
H121	Lag Bolt	3/8" x 7"	4	5-46-0784
H146	Carriage Bolt	3/8" x 1 3/4"	8	5-46-0784

## 10' Scoop Slide Parts List Continued

**3956**

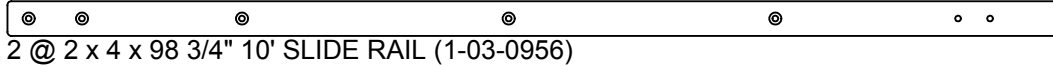

2 @ 2 x 4 x 98 3/4" 10' SLIDE RAIL (1-03-0956)

**6952**

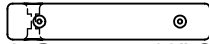

2 @ 4 x 4 x 19" SLIDE BLOCK (1-06-0952)

**7006**

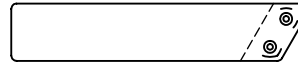

1 @ 4 x 6 x 27 3/4" LEFT SLIDE LEG (1-07-0006)

**7007**



1 @ 4 x 6 x 27 3/4" RIGHT SLIDE LEG (1-07-0007)

**7091**



1 @ 4 x 6 x 26 1/2" SLIDE BRACE (1-07-0091)

**\*NOT SHOWN:**

**N43**

1 @ 10' SCOOP SLIDE  
5-44-0263,5-44-0264

## 11' Scoop Slide Parts List

<u>F/N#</u>	<u>DESCRIPTION</u>	<u>DIMENSION</u>	<u>QTY</u>	<u>FOUND IN</u>
H3	Flat Washer	3/8"	24	5-46-0785
H4	Flat Washer	1/2"	6	5-46-0785
H11	Lock Washer	3/8"	16	5-46-0785
H17	Standard Nut	3/8"	6	5-46-0785
H21	Jam Nut	3/8"	10	5-46-0785
H28	Acorn Nut	3/8"	16	5-46-0785
H46	Carriage Bolt	3/8" x 1 3/4"	8	5-46-0785
H47	Carriage Bolt	3/8" x 2"	2	5-46-0785
H50	Carriage Bolt	3/8" x 3 1/2"	4	5-46-0785
H53	Carriage Bolt	3/8" x 5"	2	5-46-0785
H116	Lag Bolt	3/8" x 3 1/2"	4	5-46-0785
H119	Lag Bolt	3/8" x 5"	4	5-46-0239
H121	Lag Bolt	3/8" x 7"	4	5-46-0785
H174	Phillips Truss Head Screw	#12 x 1 1/2"	2	5-46-0785

**3984**

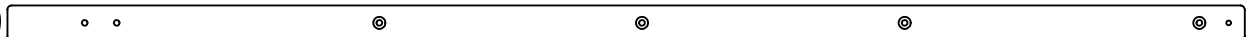

2 @ 2 x 4 x 116" 11' SLIDE RAIL (1-03-0984)

**6952**

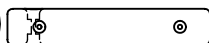

2 @ 4 x 4 x 19" SLIDE BLOCK (1-06-0952)

**7006**

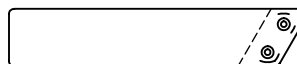

1 @ 4 x 6 x 27 3/4" LEFT SLIDE LEG (1-07-0006)

**7007**

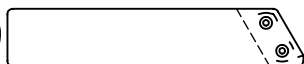

1 @ 4 x 6 x 27 3/4" RIGHT SLIDE LEG (1-07-0007)

**7091**

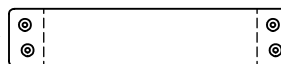

1 @ 4 x 6 x 26 1/2" SLIDE BRACE (1-07-0091)

**\*NOT SHOWN:**

**N87**

1 @ 11' SCOOP SLIDE  
5-44-0265,5-44-0266

## 24" Dia. Spiral Slide Parts List

<u>F/N#</u>	<u>DESCRIPTION</u>	<u>DIMENSION</u>	<u>QTY</u>	<u>FOUND IN</u>
H1	Flat Washer	1/4"	15	5-46-0462
H3	Flat Washer	3/8"	42	5-46-0462
H11	Lock Washer	3/8"	42	5-46-0462
H17	Standard Nut	3/8"	36	5-46-0462
H28	Acorn Nut	3/8"	36	5-46-0462
H44	Carriage Bolt	3/8" x 1 1/4"	36	5-46-0462
H108	Lag Bolt	5/16" x 3"	15	5-46-0462
H123	Hex Head Bolt	3/8" x 1 1/4"	6	5-46-0462
H154	Phillips Wood Screw	#8 x 2"	24	5-46-0462
H164	Phillips Pan Head Tap Screw	#14 x 1"	8	5-46-0462
N378	24" Dia. Long Entrance Panel		1	loose
N194	24" Dia. 90° Elbow		2	loose
N379	24" Dia. 90° Right Elbow		1	loose
N195	24" Dia. 90° Left Elbow		1	loose
N196	24" Dia. Spiral Landing		1	loose

## 62" Deck Height PC A-Frame Parts List

<u>F/N#</u>	<u>DESCRIPTION</u>	<u>DIMENSION</u>	<u>QTY</u>	<u>FOUND IN</u>
H3	Flat Washer	3/8"	5	5-46-0563
H4	Flat Washer	1/2"	12	5-46-0563
H5	Flat Washer	3/4"	10	5-46-0563
H12	Lock Washer	1/2"	11	5-46-0563
H18	Standard Nut	1/2"	11	5-46-0563
H29	Acorn Nut	1/2"	11	5-46-0563
H65	Carriage Bolt	1/2" x 3 1/2"	2	5-46-0563
H72	Carriage Bolt	1/2" x 7"	7	5-46-0563
H76	Carriage Bolt	1/2" x 9"	1	5-46-0563
H116	Lag Bolt	3/8" x 3 1/2"	2	5-46-0563
H119	Lag Bolt	3/8" x 5"	3	5-46-0563
H151	Hex Bolt	1/2" x 12"	1	5-46-0563
N401	45 Degree Bracket (5-35-0102)		2	5-21-1021
N402	90 Degree Bracket (5-35-0103)		2	5-21-1021
N400	Swing Beam Plate (5-35-0101)		1	5-21-1021
N29	Bolt Cup	3/8"	2	5-21-1021

**6007**

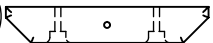

1 @ 4 x 4 x 19" LOWER A-FRAME BRACKET  
(1-06-0007)

**6008**



1 @ 4 x 4 x 19" UPPER A-FRAME BRACKET  
(1-06-0008)

**6010**



2 @ 4 x 4 x 120" 62"/64"DH A-FRAME LEG (1-06-0010)

**6021**



1 @ 4 x 4 x 70" 62"/64"DH A-FRAME CROSS MEMBER (1-06-0021)

## 66" Deck Height PC A-Frame Parts List

<u>F/N#</u>	<u>DESCRIPTION</u>	<u>DIMENSION</u>	<u>QTY</u>	<u>FOUND IN</u>
H3	Flat Washer	3/8"	5	5-46-0563
H4	Flat Washer	1/2"	12	5-46-0563
H5	Flat Washer	3/4"	10	5-46-0563
H12	Lock Washer	1/2"	11	5-46-0563
H18	Standard Nut	1/2"	11	5-46-0563
H29	Acorn Nut	1/2"	11	5-46-0563
H65	Carriage Bolt	1/2" x 3 1/2"	2	5-46-0563
H72	Carriage Bolt	1/2" x 7"	7	5-46-0563
H76	Carriage Bolt	1/2" x 9"	1	5-46-0563
H116	Lag Bolt	3/8" x 3 1/2"	2	5-46-0563
H119	Lag Bolt	3/8" x 5"	3	5-46-0563
H151	Hex Bolt	1/2" x 12"	1	5-46-0563
N401	45 Degree Bracket (5-35-0102)		2	5-21-1021
N402	90 Degree Bracket (5-35-0103)		2	5-21-1021
N400	Swing Beam Plate (5-35-0101)		1	5-21-1021
N29	Bolt Cup	3/8"	2	5-21-1021

**6007**

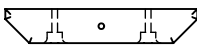

1 @ 4 x 4 x 19" LOWER A-FRAME BRACKET  
(1-06-0007)

**6008**

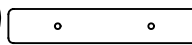

1 @ 4 x 4 x 19" UPPER A-FRAME BRACKET  
(1-06-0008)

**6052**



2 @ 4 x 4 x 126" A-FRAME LEG (1-06-1052)

**6053**



1 @ 4 x 4 x 78" A-FRAME CROSS MEMBER (1-06-1053)

## Swing Beam Parts List

**7154**



1 @ 4 x 6 x 117" 2 POSITION SWING BEAM (1-07-0154)

**7085**



1 @ 4 x 6 x 150" 3 POSITION SWING BEAM (1-07-0085)

**7084**



1 @ 4 x 6 x 180" 4 POSITION SWING BEAM (1-07-0084)

## Swing Hangers Parts List (4x4) (Per Swing)

<u>F/N#</u>	<u>DESCRIPTION</u>	<u>DIMENSION</u>	<u>QTY</u>	<u>FOUND IN</u>
H3	Flat Washer	3/8"	4	5-46-0411
H11	Lock Washer	3/8"	4	5-46-0411
H17	Standard Nut	3/8"	4	5-46-0411
H24	Nylock Nut	3/8"	4	5-46-0411
H28	Acorn Nut	3/8"	4	5-46-0411
H131	Hex Bolt	3/8" x 4 1/2"	4	5-46-0411
N26	Swing Hanger		2	5-27-0005
N29	Bolt Cup	3/8"	4	5-27-0005
N90	Spring Clip		2	5-27-0005

## Swing Hangers Parts List (4x6) (Per Swing)

<u>F/N#</u>	<u>DESCRIPTION</u>	<u>DIMENSION</u>	<u>QTY</u>	<u>FOUND IN</u>
H3	Flat Washer	3/8"	4	5-46-0410
H11	Lock Washer	3/8"	4	5-46-0410
H17	Standard Nut	3/8"	4	5-46-0410
H24	Nylock Nut	3/8"	4	5-46-0410
H28	Acorn Nut	3/8"	4	5-46-0410
H135	Hex Bolt	3/8" x 6 1/2"	4	5-46-0410
N26	Swing Hanger		2	5-27-0006
N29	Bolt Cup	3/8"	4	5-27-0006
N90	Spring Clip		2	5-27-0006

## 60"/62" DH A-Frame Bench Parts List

<u>F/N#</u>	<u>DESCRIPTION</u>	<u>DIMENSION</u>	<u>QTY</u>	<u>FOUND IN</u>
H4	Flat Washer	1/2"	3	5-46-0876
H5	Flat Washer	3/4"	21	5-46-0876
H12	Lock Washer	1/2"	3	5-46-0876
H18	Standard Nut	1/2"	3	5-46-0876
H29	Acorn Nut	1/2"	3	5-46-0876
H80	Carriage Bolt	1/2" x 11"	3	5-46-0876

**6021**

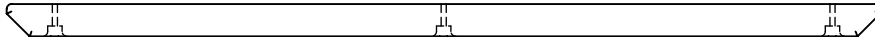

2 @ 4 x 4 x 91" A-FRAME BENCH SEAT (1-06-1021)

**6022**

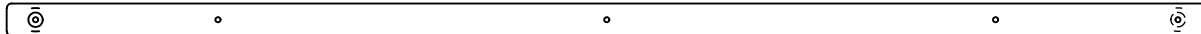

1 @ 4 x 4 x 125" A-FRAME BENCH CROSS MEMBER (1-06-1022)

## 62"/66" A-Frame Deluxe Bench Parts List

<u>F/N#</u>	<u>DESCRIPTION</u>	<u>DIMENSION</u>	<u>QTY</u>	<u>FOUND IN</u>
H3	Flat Washer	3/8"	4	5-46-0456
H4	Flat Washer	1/2"	4	5-46-0456
H5	Flat Washer	3/4"	4	5-46-0456
H12	Lock Washer	1/2"	4	5-46-0456
H18	Standard Nut	1/2"	4	5-46-0456
H29	Acorn Nut	1/2"	4	5-46-0456
H68	Carriage Bolt	1/2" x 5"	2	5-46-0456
H69	Carriage Bolt	1/2" x 5 1/2"	2	5-46-0456
H116	Lag Bolt	3/8" x 3 1/2"	10	5-46-0456
H119	Lag Bolt	3/8" x 5"	4	5-46-0456
N103	Bench Bracket		2	5-21-0461
N104	Bench Support Bracket		2	5-21-0461
N29	Bolt Cup	3/8"	10	5-21-0461

**6007**

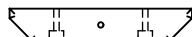

1 @ 4 x 4 x 19" LOWER A-FRAME BRACKET (1-06-0007)

**6008**

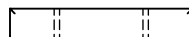

1 @ 4 x 4 x 19" UPPER A-FRAME BRACKET (1-06-0008)

**7905**



2 @ 4 x 6 x 126" A-FRAME LEG (1-07-0905)

**7651**



2 @ 4 x 6 x 58" SEAT BACK (1-07-0651)

**7868**



1 @ 4 x 6 x 135" SEAT A-FRAME CROSS MEMBER (1-07-0868)

**7816**



1 @ 4 x 6 x 58" SEAT (1-07-0816)

## 2 & 3 Position Dual Attach Swing Beam Parts List

<u>F/N#</u>	<u>DESCRIPTION</u>	<u>DIMENSION</u>	<u>QTY</u>	<u>FOUND IN</u>
H4	Flat Washer	1/2"	8	5-46-0786
H5	Flat Washer	3/4"	8	5-46-0786
H12	Lock Washer	1/2"	8	5-46-0786
H18	Standard Nut	1/2"	8	5-46-0786
H29	Acorn Nut	1/2"	8	5-46-0786
H65	Carriage Bolt	1/2" x 3 1/2"	4	5-46-0786
H72	Carriage Bolt	1/2" x 7"	2	5-46-0786
H76	Carriage Bolt	1/2" x 9"	2	5-46-0786
N56	Swing Beam Plate (5-35-0000)		2	5-21-0862

\*NOTE: The 2 and 3 Position Dual Attach Swing Beams use the same Hardware bag.

7863



1 @ 4 x 6 x 108" 2 POS DUAL ATTCH SB (1-07-0863)

7820



1 @ 4 x 6 x 142" 3 POS DUAL ATTCH SB (1-07-0820)

## 62"/66" Deck Height Swing Options

<u>F/N#</u>	<u>DESCRIPTION</u>	<u>DIMENSION</u>	<u>QTY</u>	<u>FOUND IN</u>
N211	Sling Swing w/72" Chain			Loose
N297	Bucket Swing w/72" Chain			Loose
N336	Trapeze/Ring Combo w/26" Chain			Loose
N91	Swing Disk and Rope			Loose
N92	Buoy Ball with Rope, Cap, and Inflator			5-27-0009

## 2 Chain Tire Swing Parts List

<u>F/N#</u>	<u>DESCRIPTION</u>	<u>DIMENSION</u>	<u>QTY</u>	<u>FOUND IN</u>
N320	Chain	72"	2	5-21-1060
N409	2 Chain Tire		1	Loose
N30	C-Link		2	5-21-1060

## 4 Chain Tire Swing Parts List

<u>F/N#</u>	<u>DESCRIPTION</u>	<u>DIMENSION</u>	<u>QTY</u>	<u>FOUND IN</u>
N317	4 Chain Tire Chain Assembly	27"/35"	2	5-21-1064
N410	4 Chain Tire		1	Loose
N30	C-Link		4	5-21-1064

## Buoy Ball Parts List

<u>F/N#</u>	<u>DESCRIPTION</u>	<u>DIMENSION</u>	<u>QTY</u>	<u>FOUND IN</u>
N223	Chain	44"	1	5-27-0003/5-27-0004
N224	Buoy Ball		1	5-27-0003/5-27-0004
N90	Spring Clips		2	5-27-0003/5-27-0004
N225	Buoy Ball Inflator		1	5-27-0003/5-27-0004

## Punching Bag Parts List

<u>F/N#</u>	<u>DESCRIPTION</u>	<u>DIMENSION</u>	<u>QTY</u>	<u>FOUND IN</u>
N275	48" Chain		1	5-20-0378
N385	Punching Bag		1	5-20-0378
N30	6 mm C-Link		1	5-20-0378

## Box Kit Glider Hardware List

<u>F/N#</u>	<u>DESCRIPTION</u>	<u>DIMENSION</u>	<u>QTY</u>	<u>FOUND IN</u>
H1	Flat Washer	1/4"	4	5-46-0754
H3	Flat Washer	3/8"	10	5-46-0754
H4	Flat Washer	1/2"	4	5-46-0754
H11	Lock Washer	3/8"	10	5-46-0754
H17	Standard Nut	3/8"	4	5-46-0754
H24	Nylock Nut	3/8"	2	5-46-0754
H28	Acorn Nut	3/8"	6	5-46-0754
H57	Carriage Bolt	3/8" x 7"	4	5-46-0754
H100	Lag Bolt	1/4" x 4 1/2"	4	5-46-0754
H139	Hex Head Bolt	3/8" x 9"	2	5-46-0754
H140	Hex Head Bolt	3/8" x 10"	2	5-46-0754

## Box Kit Glider Parts List

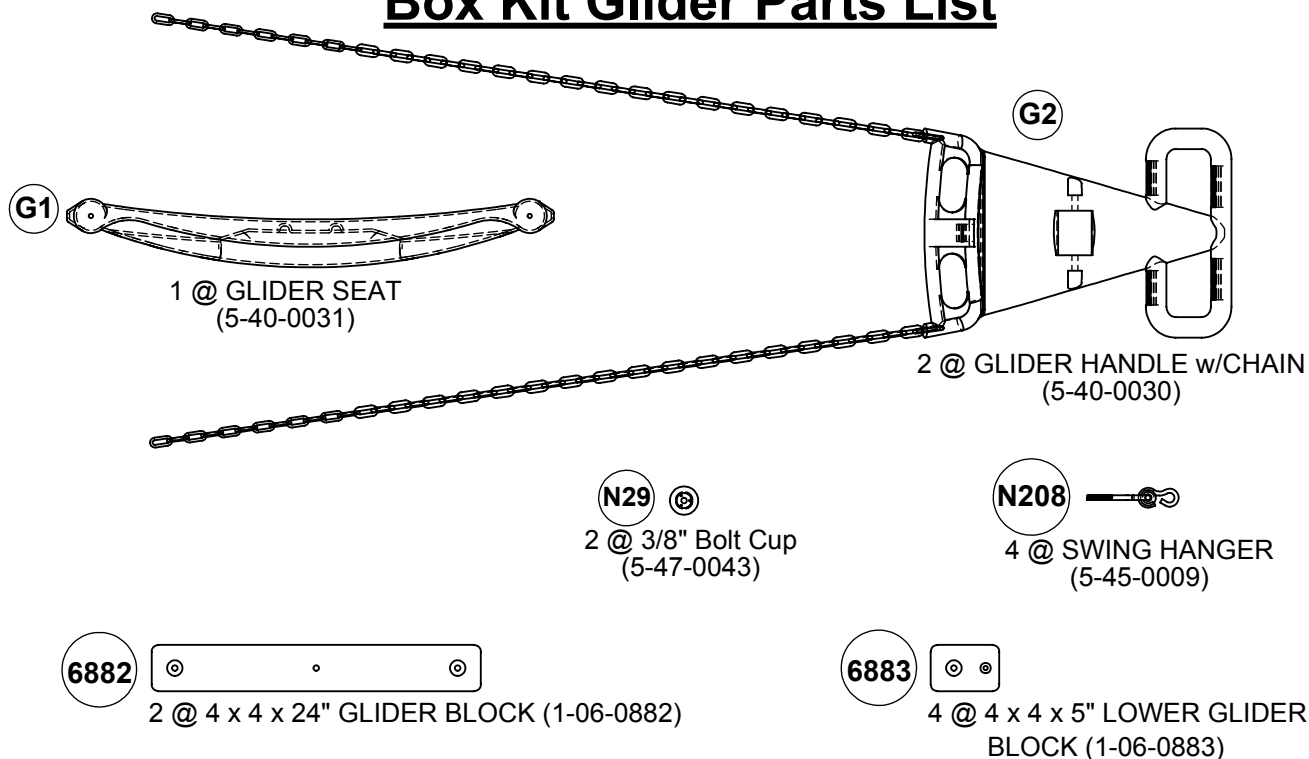

## Glider Parts List

<u>F/N#</u>	<u>DESCRIPTION</u>	<u>DIMENSION</u>	<u>QTY</u>	<u>FOUND IN</u>
H3	Flat Washer	3/8"	28	5-46-0705
H11	Lock Washer	3/8"	20	5-46-0705
H24	Nylock Nut	3/8"	8	5-46-0705
H28	Acorn Nut	3/8"	8	5-46-0705
H34	4 Prong T-Nut	3/8"	12	5-46-0705
H135	Hex Bolt	3/8" x 6 1/2"	8	5-46-0705
H138	Hex Bolt	3/8" x 8"	8	5-46-0705
H139	Hex Bolt	3/8" x 9"	4	5-46-0705
N221	Glider w/ 64" Chain		1	5-21-0728/729

\*NOTE: Gliders come pre-packaged with their own Hardware.

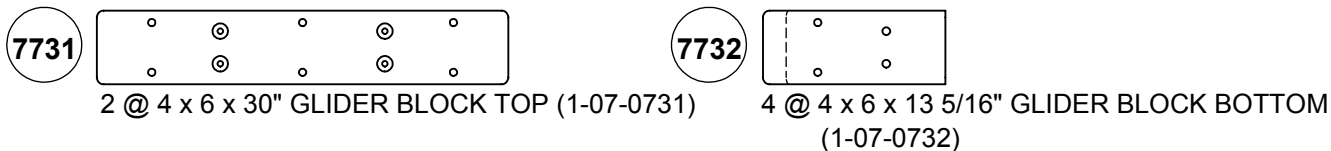



## 2 Hole Mount 4x6 Chin-Up Bar Parts List

<u>F/N#</u>	<u>DESCRIPTION</u>	<u>DIMENSION</u>	<u>QTY</u>	<u>FOUND IN</u>
H3	Flat Washer	3/8"	2	5-46-0710
H11	Lock Washer	3/8"	2	5-46-0710
H30	Round Pallet Nut	3/8"	2	5-46-0710
H133	Hex Head Bolt	3/8" x 5 1/2"	2	5-46-0710

**N380**



1 @ CHIN-UP BAR  
2 HOLE MOUNT  
(5-33-0122)

## 4 Hole Mount 4x6 Chin-Up Bar Parts List

<u>F/N#</u>	<u>DESCRIPTION</u>	<u>DIMENSION</u>	<u>QTY</u>	<u>FOUND IN</u>
H3	Flat Washer	3/8"	4	5-46-0710
H11	Lock Washer	3/8"	4	5-46-0710
H30	Round Pallet Nut	3/8"	4	5-46-0710
H133	Hex Head Bolt	3/8" x 5 1/2"	4	5-46-0710

**N406**



1 @ CHIN-UP BAR  
4 HOLE MOUNT  
(5-33-0128)

## 2 Hole Mount 4x4 Chin-Up Bar Parts List

<u>F/N#</u>	<u>DESCRIPTION</u>	<u>DIMENSION</u>	<u>QTY</u>	<u>FOUND IN</u>
H3	Flat Washer	3/8"	2	5-46-0922
H11	Lock Washer	3/8"	2	5-46-0922
H30	Round Pallet Nut	3/8"	2	5-46-0922
H129	Hex Head Bolt	3/8" x 3 1/2"	2	5-46-0922

**N380**



1 @ CHIN-UP BAR  
2 HOLE MOUNT  
(5-33-0122)

## 4 Hole Mount 4x4 Chin-Up Bar Parts List

<u>F/N#</u>	<u>DESCRIPTION</u>	<u>DIMENSION</u>	<u>QTY</u>	<u>FOUND IN</u>
H3	Flat Washer	3/8"	4	5-46-0922
H11	Lock Washer	3/8"	4	5-46-0922
H30	Round Pallet Nut	3/8"	4	5-46-0922
H129	Hex Head Bolt	3/8" x 3 1/2"	4	5-46-0922

**N406**



1 @ CHIN-UP BAR  
4 HOLE MOUNT  
(5-33-0128)

## Fire Pole Parts List

<u>F/N#</u>	<u>DESCRIPTION</u>	<u>DIMENSION</u>	<u>QTY</u>	<u>FOUND IN</u>
H3	Flat Washer	3/8"	2	5-46-0880
H11	Lock Washer	3/8"	2	5-46-0880
H34	4 Prong T-Nut	3/8"	2	5-46-0880
H116	Lag Bolt	3/8" x 3 1/2"	2	5-46-0880
H123	Hex Head Bolt	3/8" x 1 1/4"	2	5-46-0880
H125	Hex Head Bolt	3/8" x 1 3/4"	2	5-46-0880
H226	Phillips Pan Head Self Drilling Screw	#10 x 1"	2	5-46-0880

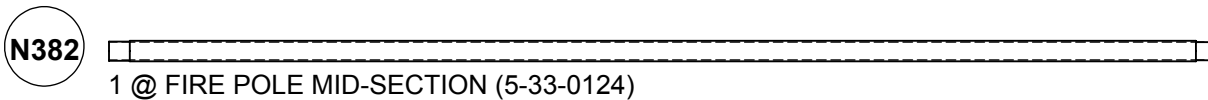
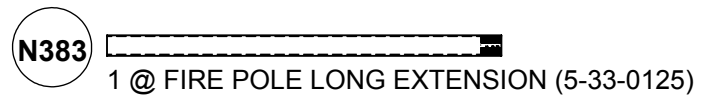
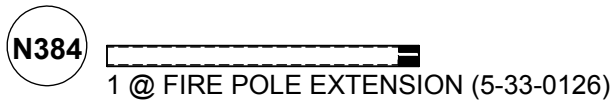
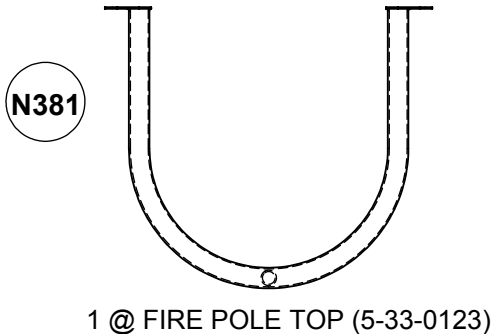

## Cork Screw Climber Parts List

<u>F/N#</u>	<u>DESCRIPTION</u>	<u>DIMENSION</u>	<u>QTY</u>	<u>FOUND IN</u>
H3	Flat Washer	3/8"	2	5-46-0880
H11	Lock Washer	3/8"	2	5-46-0880
H34	4 Prong T-Nut	3/8"	2	5-46-0880
H116	Lag Bolt	3/8" x 3 1/2"	2	5-46-0880
H123	Hex Head Bolt	3/8" x 1 1/4"	2	5-46-0880
H125	Hex Head Bolt	3/8" x 1 3/4"	2	5-46-0880
H226	Phillips Pan Head Self Drilling Screw	#10 x 1"	2	5-46-0880

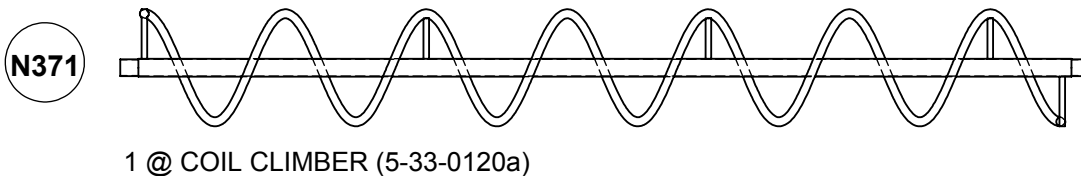
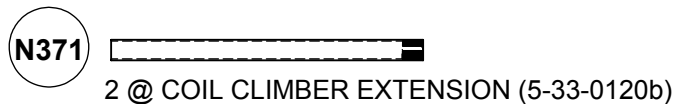
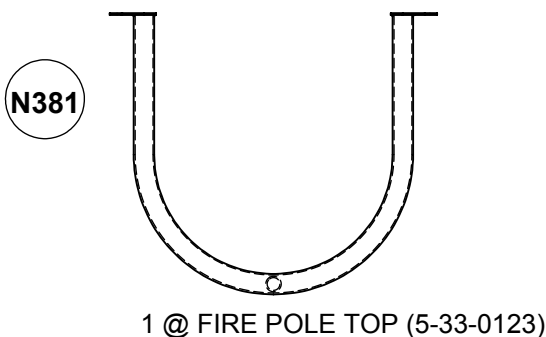

## Wacky Sign Boards Hardware List

<u>F/N#</u>	<u>DESCRIPTION</u>	<u>DIMENSION</u>	<u>QTY</u>	<u>FOUND IN</u>
H176	Phillips Wood Screw	#8 x 1"	12	5-46-0808

## Wacky Sign Boards Parts List

**1229**   
 1 @ 1 x 4 x 36" NO TRESPASSING  
 (1-01-0229)

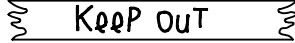
**1225**   
 1 @ 1 x 4 x 24" KEEP OUT (1-01-0225)

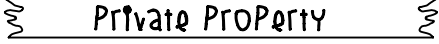
**1230**   
 1 @ 1 x 4 x 36" PRIVATE PROPERTY  
 (1-01-0230)

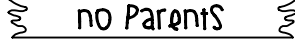
**1226**   
 1 @ 1 x 4 x 24" NO PARENTS (1-01-0226)

## Driving Panel Parts List

<u>F/N#</u>	<u>DESCRIPTION</u>	<u>DIMENSION</u>	<u>QTY</u>	<u>FOUND IN</u>
H1	Flat Washer	1/4"	2	5-41-0049
H2	Flat Washer	5/16"	2	5-41-0049
H23	Nylock Nut	5/16"	1	5-41-0049
H97	Lag Bolt	1/4" x 3"	2	5-41-0049
H222	Hex Head Bolt	5/16" x 2 1/2"	1	5-41-0049
H221	Phillips Pan Head Tap Screw	#10 x 3"	4	5-41-0049

**N328**   
 1 @ DRIVING PANEL  
 (5-41-0049)

**N328**   
 1 @ STEERING WHEEL  
 (5-41-0049)

**N328**   
 1 @ STEERING WHEEL CAP  
 (5-41-0049)





# Step 1

## First Wall Assembly (without Rock Wall)

\*NOTE: Predrill 1/8" holes for all 5/16" Lag Bolts.

\*NOTE: If installing Rock Wall, skip to Step 2.

\*NOTE: Processes are shown assembling the Carnival Clubhouse. Processes will be the same if installing the Turbo Carnival Clubhouse unless otherwise noted.

\*NOTE: If installing Lower Level Playhouse, skip to Step 4.

\*NOTE: Refer to INSET A if the Accessory Arm (6303) needs to be cut down.

1. Line up holes in Main Beam (7058) with the lower holes in Corner Uprights (6302) (6324) and attach Main Beam to Uprights using 1/2" Hardware (H4) and 3/8" Hardware (H3) (H11) (H17) (H115).

\*NOTE: Uprights (6324) will be used if assembling the Turbo Carnival Clubhouse.

\*NOTE: Counter bored holes in Main Beam (7058) must be facing out as shown in Inset B.

2. Attach Accessory Arm (6303) through upper holes in Corner Uprights (6302) (6324) using 1/2" Hardware (H4) and 3/8" Hardware (H3) (H11) (H17) (H56).

\*NOTE: Depending on your set configuration the Accessory may be flipped to run out the back side of the set.

3. Ensure wall assembly is plumb and square and attach 4 Hole Facia (4133) to bottoms of Corner Uprights using 1/4" Hardware (H1) and 5/16" Hardware (H108). Facia must be flush with bottoms and outside faces of Uprights when properly installed. Uprights must measure 58" apart.

4. Position Left and Right Slim Brackets (6107) (6108) against Uprights (6302) (6324) and Main Beam (7058) and attach using 3/8" Hardware (H3) (H115) (H116). 3/8" Hardware (H115) must be installed into the holes going into the Main Beams (7058).

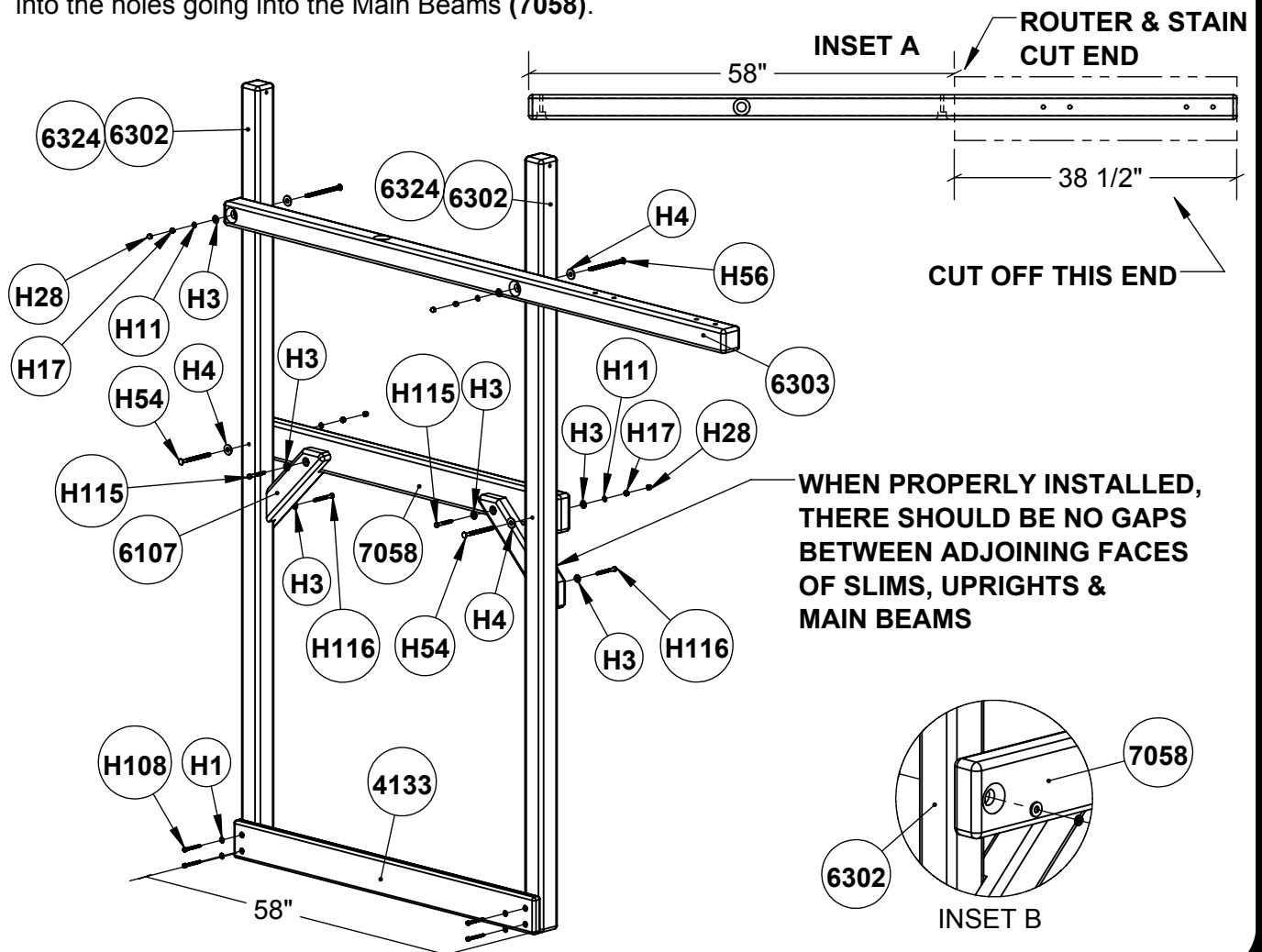

# Step 2

## First Wall Assembly (with Rock Wall)

**\*NOTE:** Predrill 1/8" holes for all 5/16" Lag Bolts.

**\*NOTE:** Processes are shown assembling the Carnival Clubhouse. Processes will be the same if installing the Turbo Carnival Clubhouse unless otherwise noted.

**\*NOTE:** Refer to **INSET A** if the Accessory Arm (6303) needs to be cut down.

1. Attach Accessory Arm (6303) through upper holes in Corner Uprights (6302) (6324) using 1/2" Hardware (H4) and 3/8" Hardware (H3) (H11) (H17) (H28) (H56).

**\*NOTE:** Uprights (6324) will be used if assembling the Turbo Carnival Clubhouse.

**\*NOTE:** Depending on your set configuration the Accessory may be flipped to run out the back side of the set.

2. Line up holes in Main Beam (7058) with the lower holes in Corner Uprights (6302) (6324). Insert 1/2" Hardware (H4) and 3/8" Hardware (H56) through holes to hold Main Beam in place. Do not attach.

**\*NOTE:** Counter bored holes in Main Beam (7058) must be facing out as shown in Inset B.

3. Ensure wall assembly is plumb and square and attach 4 Hole Facia (4133) to bottoms of Corner Uprights using 1/4" Hardware (H1) and 5/16" Hardware (H108). Facia must be flush with bottoms and outside faces of Uprights when properly installed. Uprights must measure 58" apart. Orient Facias as shown in Inset C.

4. Position Left and Right Slim Brackets (6107) (6108) against Uprights (6302) (6324) and Main Beam (7058) and attach using 3/8" Hardware (H3) (H115) (H116). 3/8" Hardware (H115) must be installed into the holes going into the Main Beams (7058).

5. Remove previously installed Hardware (H4) (H56) from Uprights and Main Beam. Main Beam will stay in place.

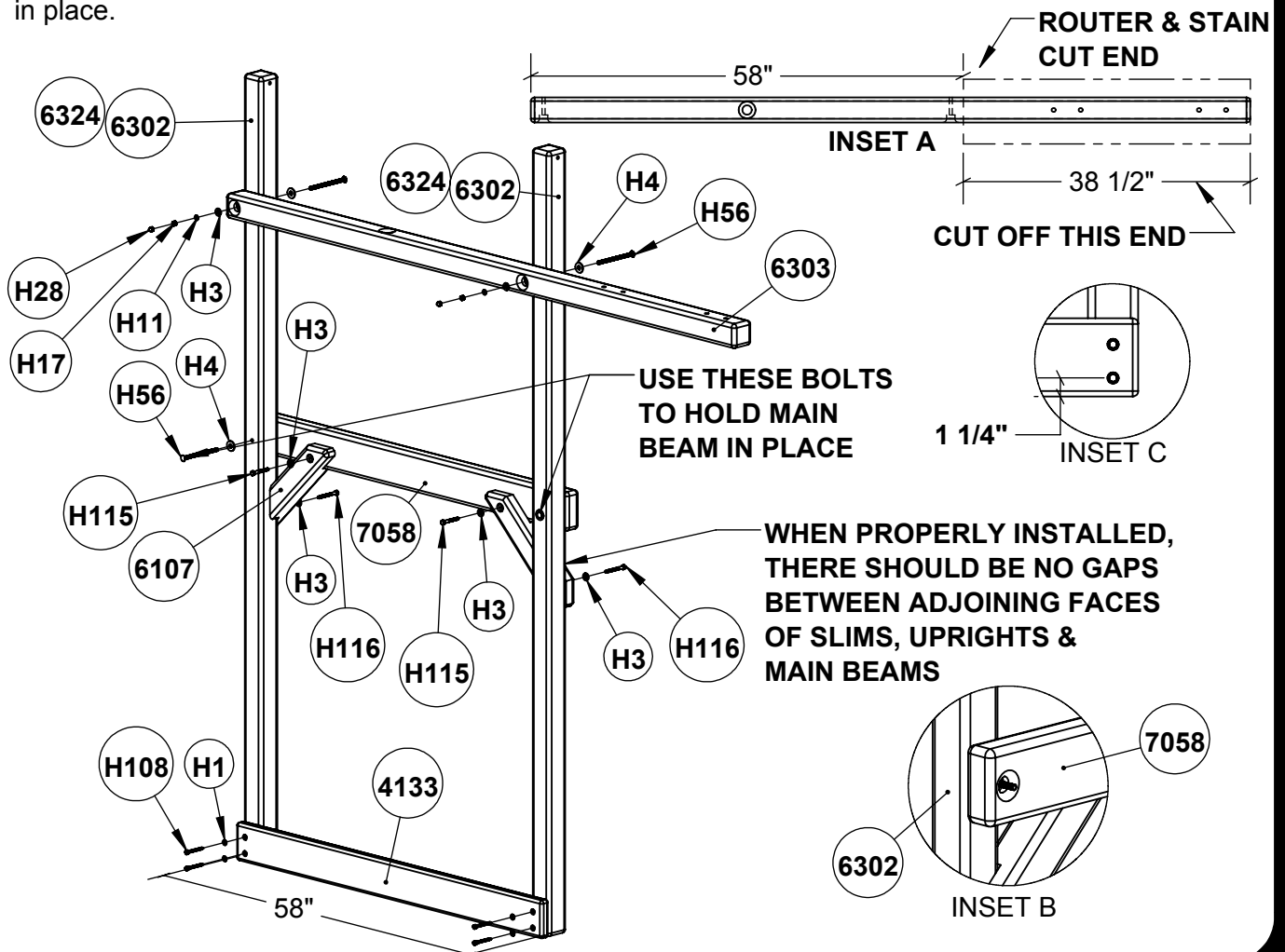

# Step 3

## First Wall Assembly (with Rock Wall)

**\*NOTE:** Pre-drill 1/8" holes for all 5/16" Lag Bolts.

1. Attach Rock Wall Mounting Facia (0145) to Corner Uprights (6202) (6324) through bottom pre-drilled holes in Facia and Main Beam (7058) using 1/2" Hardware (H4) and 3/8" Hardware (H3) (H11) (H17) (H28) (H56).

**\*NOTE:** Counter bored holes in Rock Wall Mounting Facia should be up when properly installed.

2. Install 1/4" Hardware (H1) and 5/16" Hardware (H108) into top holes in Rock Wall Mounting Facia (0145).

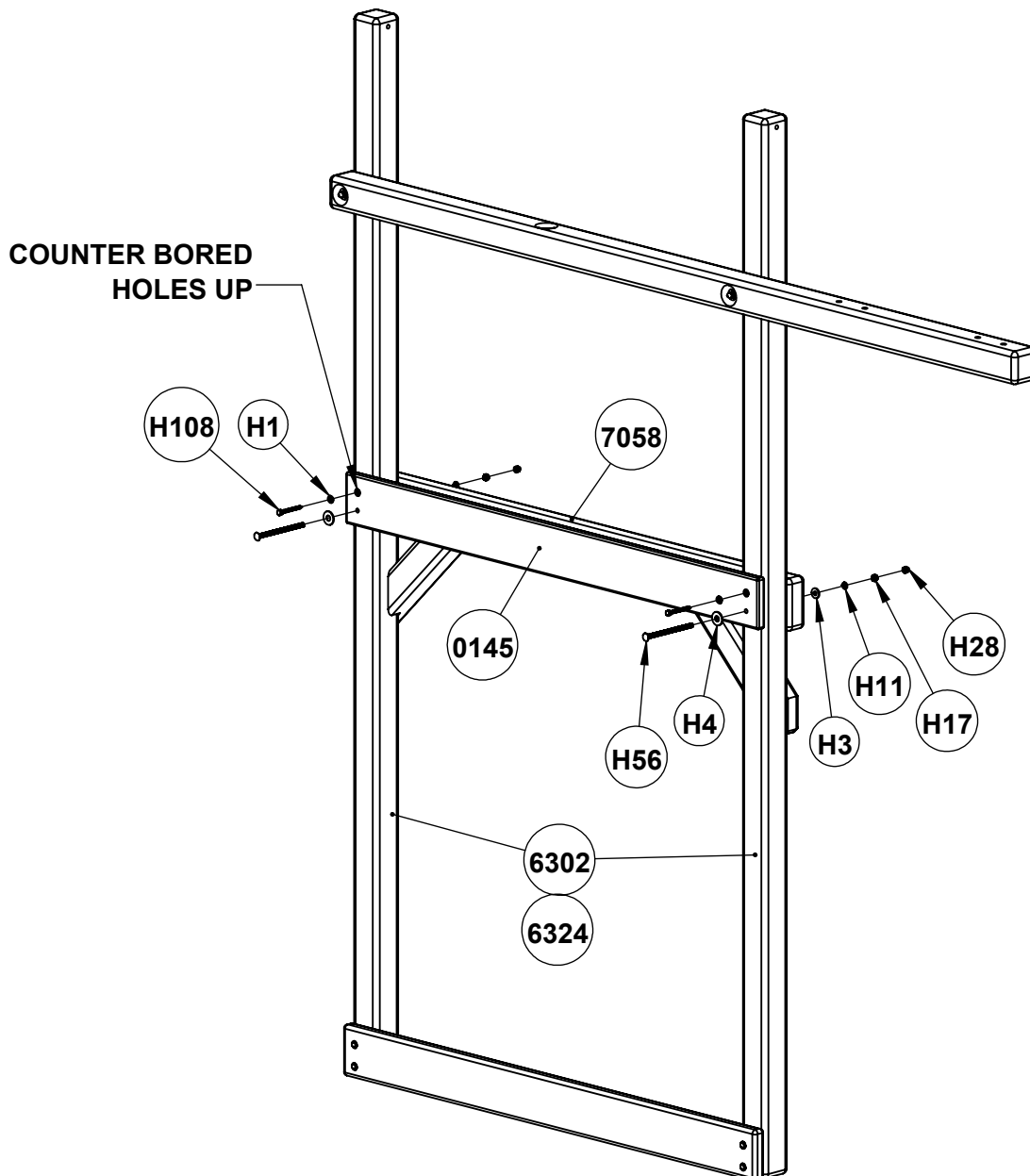



# Step 4

## Lower Level Playhouse Upright Installation

**\*NOTE:** If installing the Lower Level Playhouse on the Carnival Clubhouse, Playhouse Uprights (1267) (1268) (2073) will have to be attached to Rock Wall Mounting Facias (0145) and 2 Hole Facias (9233), prior to building wall assemblies. If installing Lower Level Playhouse on the Turbo Carnival Clubhouse, DO NOT install Playhouse Uprights (1267) (1268) (2073) on the backs of Rock Wall Mounting Facias.

1. Locate both Rock Wall Mounting Facias (0145) and 2 Hole Facias (9233) and layout Playhouse Uprights (1267) (1268) (2073) using measurements shown in Inset A.

**\*NOTE:** Be sure to position Uprights so that all the predrill holes line up.

**\*NOTE:** Counter bored holes on fronts of Rock Wall Mounting Facias must be positioned up when properly installed (as shown in Inset B).

**\*NOTE:** There will be minimal gaps between Playhouse Uprights.

2. Attach Playhouse Uprights (1267) (1268) (2073) to Rock Wall Mounting Facias (0145) and 2 Hole Facias (9233) using #8 Hardware (H194).

**\*NOTE:** Bottoms of Playhouse Uprights (1267) (2073) will be flush with bottom of 2 Hole Facia (9233) when properly installed.

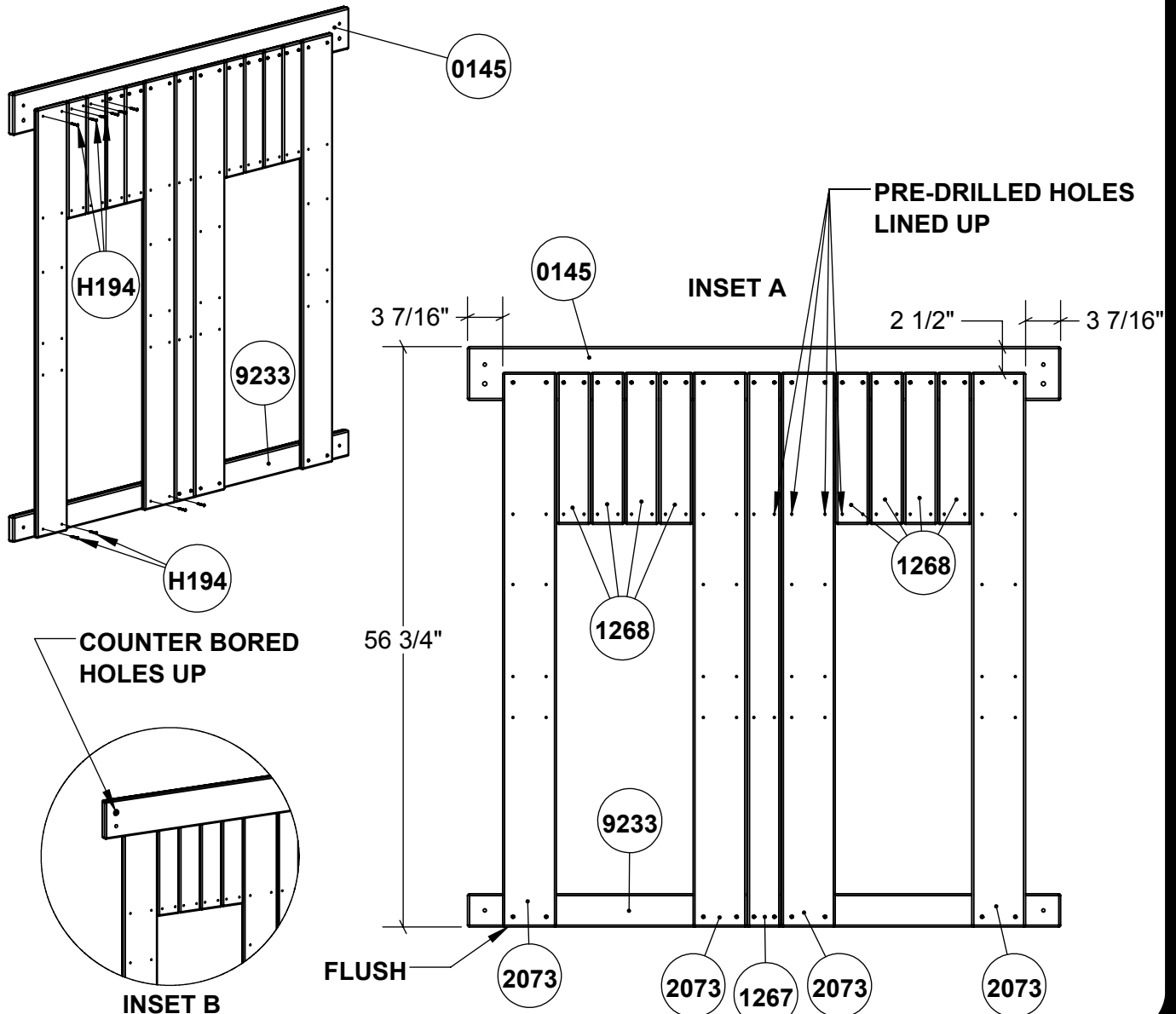

# Step 5

## First Wall Assembly (with Lower Level Playhouse)

\*NOTE: Pre-drill 1/8" holes for all 5/16" Lag Bolts.

\*NOTE: Depending on your set configuration the Accessory Arm (6303) may be flipped to run out the back of the set. If the Accessory Arm needs to be cut down refer to Step 1 for measurements to cut down Accessory Arm.

\*NOTE: Corner Uprights (6324) will be used to Assemble the Turbo Carnival Clubhouse.

\*NOTE: Playhouse Uprights should not have been attached to Rock Wall Mounting Facia if installing the Turbo Carnival Clubhouse

1. Position the Accessory Arm (6303) against Corner Uprights (6302) (6324) and attach using 1/2" Hardware (H4) and 3/8" Hardware (H3) (H11) (H17) (H28).
  2. Position 4 Hole Facia (4133) against Corner Uprights (6302) (6324) and attach using 1/4" Hardware (H1) and 5/16" Hardware (H108). Ends and bottom of Facia must be flush with bottoms and outside faces of Uprights when properly installed.
  3. Position Rock Wall Mounting Facia (0145), with previously attached Playhouse Uprights, against Corner Uprights (6302) (6324).
  4. Attach Facia (0145) through Uprights and Main Beam (7058) using 1/2" Hardware (H4) and 3/8" Hardware (H3) (H11) (H17) (H28) (H56).
- \*NOTE: 2 Hole Facia (9233) should sit directly on top of 4 Hole Facia (4133).
5. Finish attaching Rock Wall Mounting Facia (0145) and 2 Hole Facia (9233) to Uprights (6302) (6324) using 1/4" Hardware (H1) and 5/16" Hardware (H108).

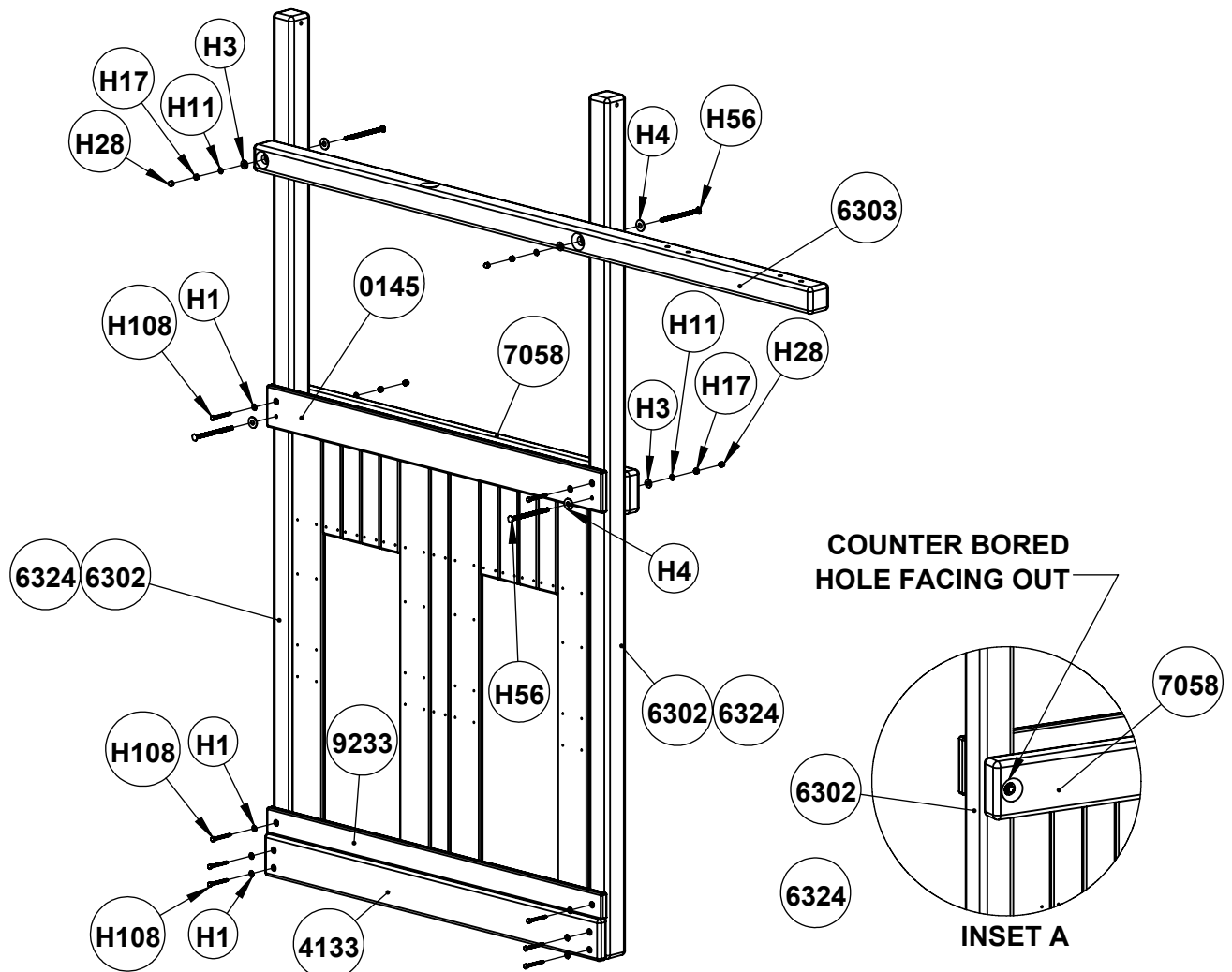

# Step 6

## Second Wall Assembly

**\*NOTE:** If installing Lower Level Playhouse skip to Step 8.

**\*NOTE:** Pre-drill 1/8" holes for all 5/16" Lag Bolts.

**\*NOTE:** Corner Uprights (6324) will be used if installing the Turbo Carnival Clubhouse.

1. Position Top Joist against Corner Uprights (6302) (6324) and attach using 1/2" Hardware (H4) and 3/8" Hardware (H3) (H11) (H17) (H28) (H56).
2. Position Main Beam (7058) against Uprights (6302) (6324) and attach using 1/2" Hardware (H4) and 3/8" Hardware (H3) (H11) (H17) (H28) (H54).

**\*NOTE:** Counter bored holes in Main Beam must be facing out (as shown in Inset A).

3. Ensure wall assembly is square and plumb and attach 4 Hole Facia (4133) to Corner Uprights (6302) (6324) using 1/4" Hardware (H1) and 5/16" Hardware (H108).

**\*NOTE:** Ends and bottom of Facia must be flush with bottoms and outside faces of Uprights when properly installed. Uprights will measure 58" apart.

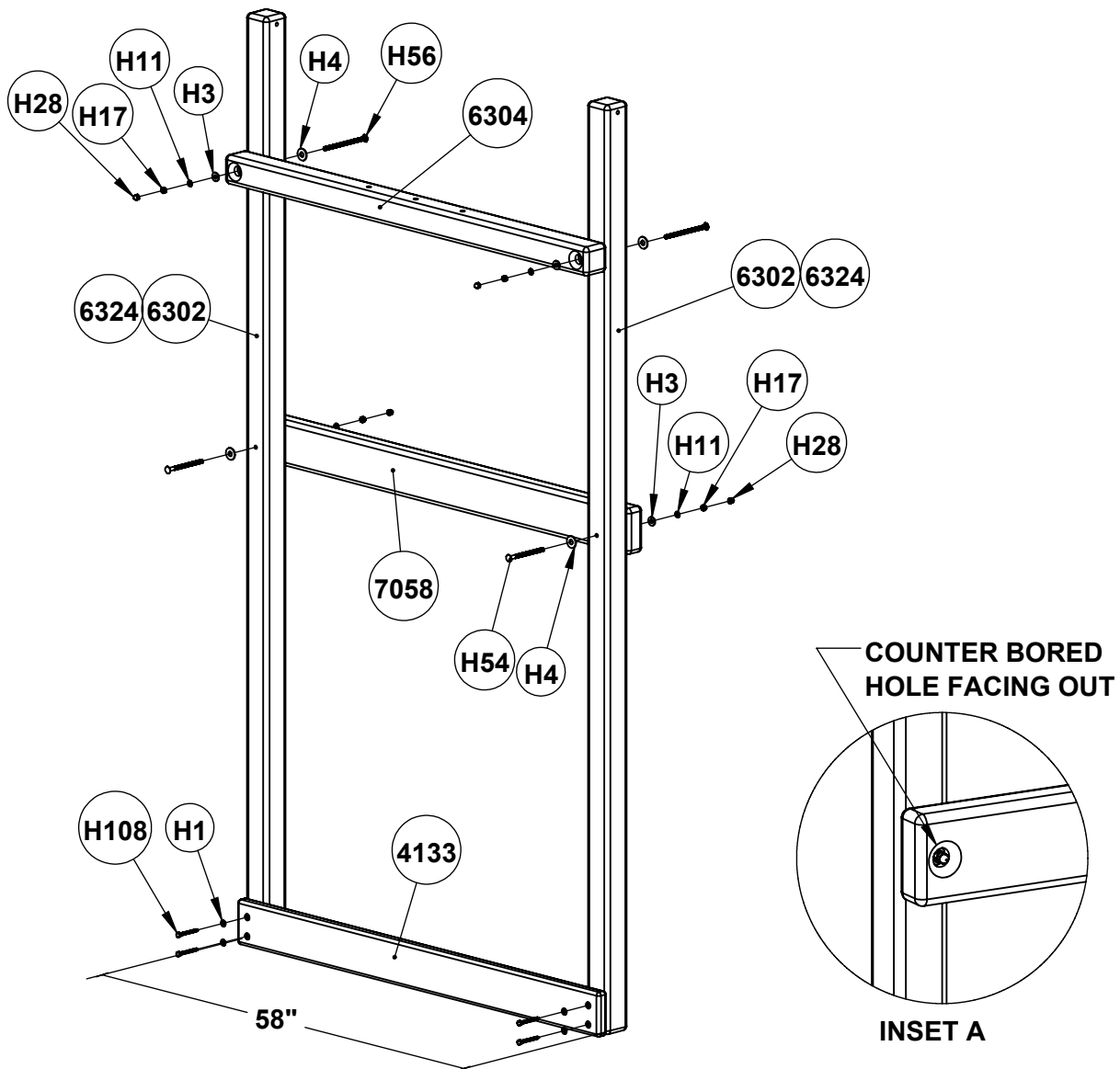

# Step 7

## Second Wall Assembly

**\*NOTE:** Pre-drill 1/4" holes for all 3/8" Lag Bolts.

1. Position Left and Right Slim Brackets (6107) (6108) against Corner Uprights (6302) (6324) and Main Beam (7058) and attach using 3/8" Hardware (H3) (H115) (H116).

**\*NOTE:** Be sure to use the 3/8" Hardware (H115) in the holes going into the Main Beam (7058).

**\*NOTE:** There should be no gaps between adjoining faces of Slims, Uprights and Main Beam when properly installed.

**\*NOTE:** If installing Picnic Table, do not install 4 Hole Facia (0128).

2. Measure up 28 1/4" on Corner Uprights (6302) (6324) and attach 4 Hole Facia (0128) using 1/4" Hardware (H1) and 5/16" Hardware (H108).

